

CN

SOUTHERN REGION

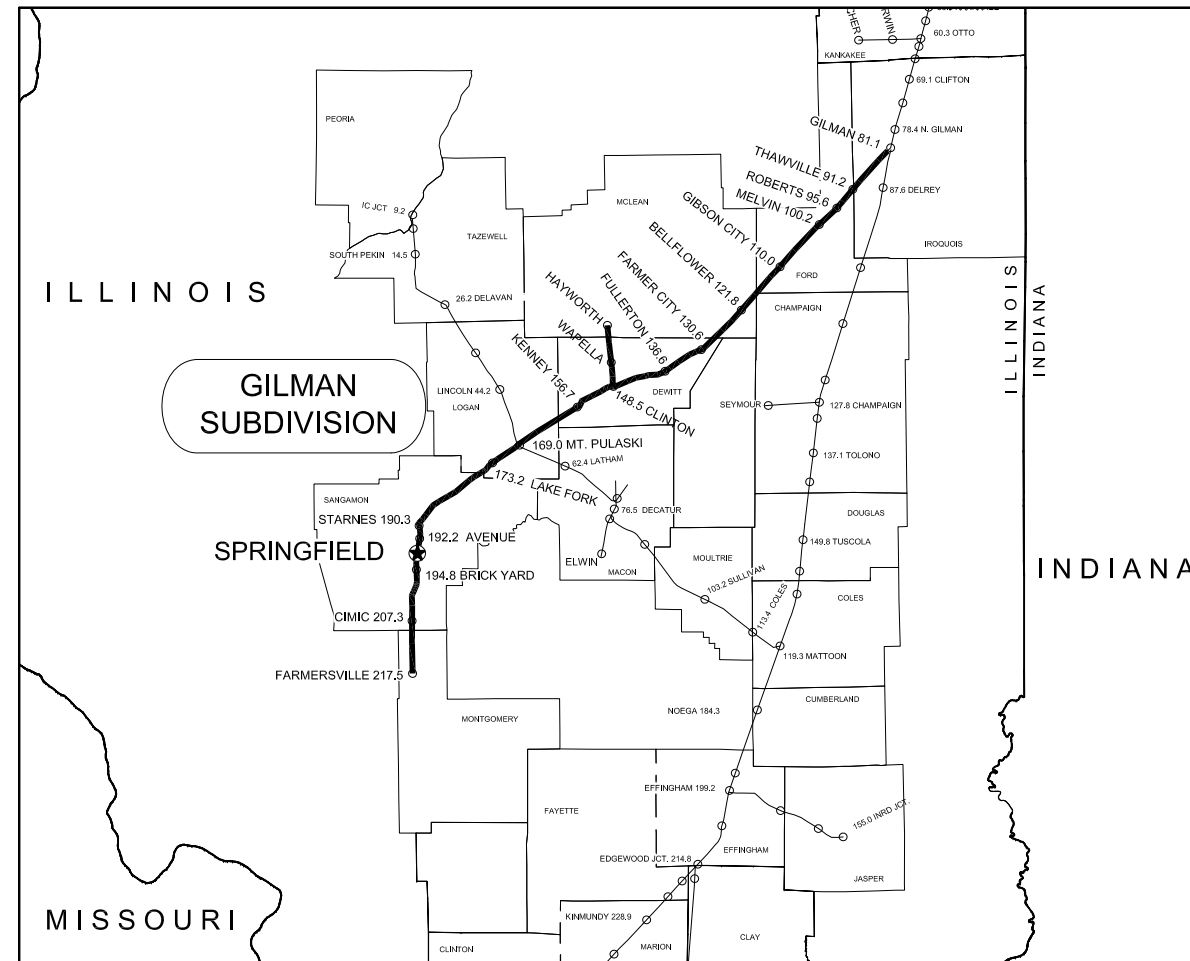

TABLE OF CONTENTS

<i>CITY/TOWN</i>	<i>PAGE #</i>
GILMAN	1
THAWVILLE	3
ROBERTS	4
MELVIN	5
GIBSON CITY	7
BELLFLOWER	9
FARMER CITY	11
FULLERTON	12
CLINTON	14
KENNEY	16
S. KENNEY	16
N. MT. PULASKI	18
MT. PULASKI	18
LAKE FORK	19
STARNES	23
AVENUE	23
BRICK YARD	23
CIMIC	26
FARMERSVILLE	28

MIDWEST ZONE / CENTRAL DIVISION GILMAN SUBDIVISION TRACK CHART

AUGUST 2015

LEGEND

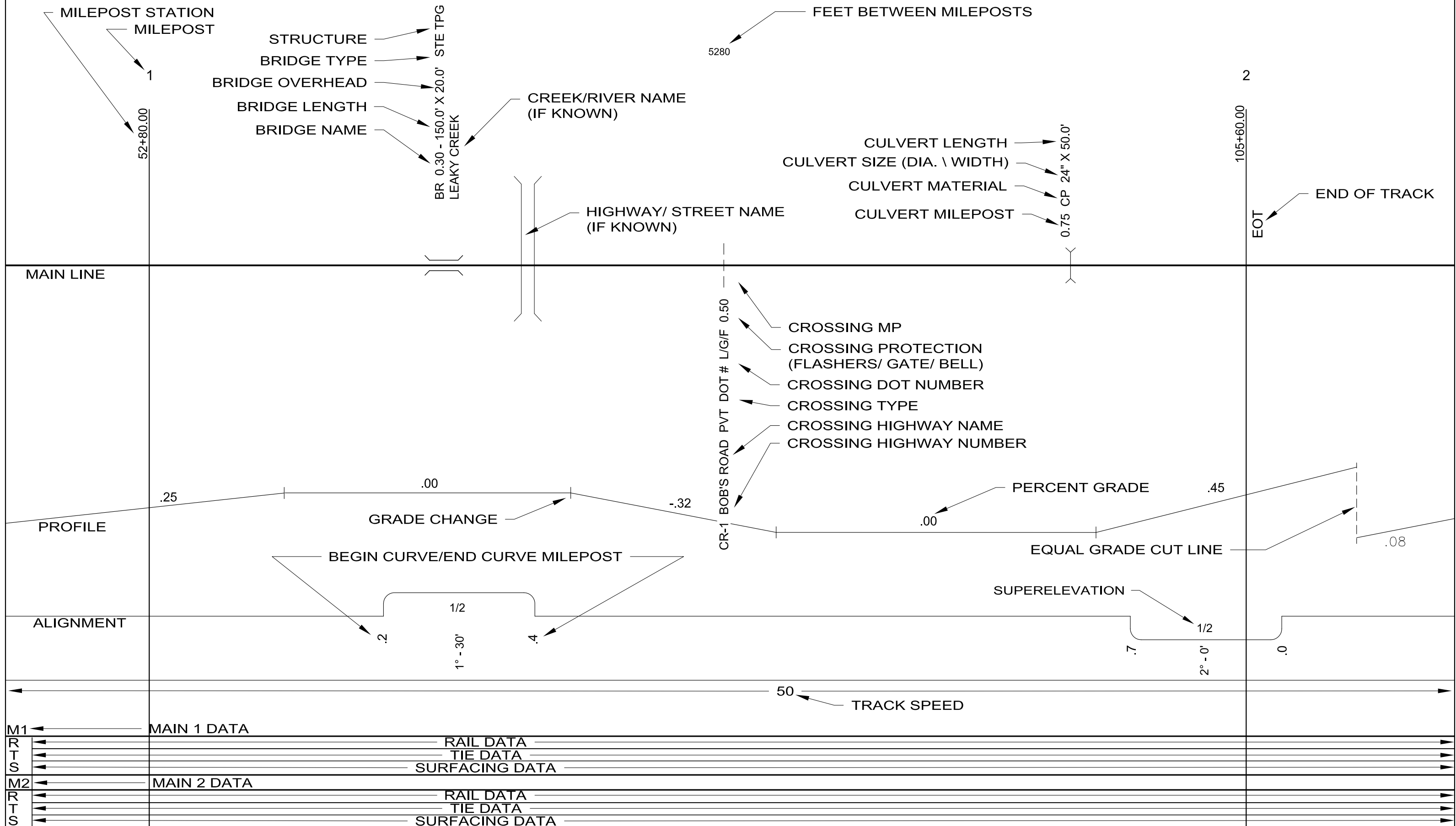

81 82 83 84 85

14987+87 5280 47+48 5280 100+28 5285 153+13 5281 205+94

GILMAN
81.1

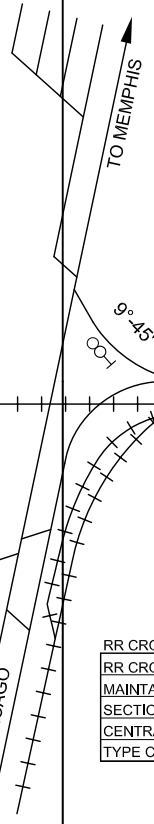

VTC 24" X 30"
CIR 24" X 50"

BR 81.50 - 12'
ARCH MIX

BR 81.80 - 225'
I-57 NB BMS 289295V
BR 81.81 - 225'
I-57 SB BMS 289295V

0.10 CIR 24" X 34"
0.20 CIR 36" X 36"
0.20 CIR 36" X 21"

TO. MP 82.53 NO.10

0.40 CIR 24" X 24"

0.60 CIR 24" X 24"

BR 84.50 - 48'
DRAIN RCS

0.90 CIR 36" X 36"

TP&W

RR CROSSING MP	81.3
RR CROSSED	TP & W
MAINTAINED BY	CN
SECTION & WEIGHT	136
CENTRAL ANGLE	8° 10' 16"
TYPE CROSSING	OWLS

PVT 289294N 0.60

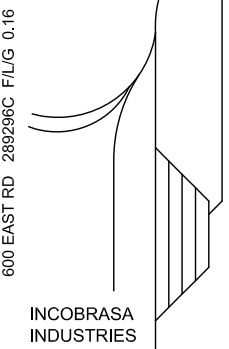

600 EAST RD 289296C F/L/G 0.16

1700 N RD 289297J F/L/G 0.96

500 E RD 289299X X 0.60

PVT 289300P 0.95

1600 N RD 289301W X 0.30

400 E RD 289302D X 0.95

PROFILE

PROFILE

ALIGNMENT

ALIGNMENT

AUTHORIZED SPEEDS

AUTHORIZED SPEEDS

M1

M1

M2

M2

GILMAN SUBDIVISION

1" = 1800'
AUGUST 2015

TO FARMERSVILLE
MP 80.00 - 85.00

PG 01 - 28

85 5280 86 5285 87 5282 88 5283 89 5283 90

205+94 258+74 311+59 364+41 417+24 470+07

MEASURED MILE

D851
D852

0.50 CIR 24" X 36"
0.70 CIR 24" X 30"

1500 N RD 289303K X 0.70

CR 1450 N 289304S F/L 0.40

0.80 CIR 24" X 42"

D874
D875

BR 87.60 - 210'
DRAIN RCS

200 E RD 289306F F/L/G 0.80

BR 88.10 - 80'
DRAIN PCT

PVT 289307M 0.20

PVT 289308U 0.60

PVT 289309B 0.10

0.20 CIR 24" X 24"

100 E RD 289310V X 0.20

D899



PROFILE

PROFILE

ALIGNMENT

ALIGNMENT

AUTHORIZED SPEEDS

AUTHORIZED SPEEDS

50

.4

60

115 CWR / 70 (GAS)

115 / 99 (GAS)

115 CWR / 70 (GAS)

115 / 54

M1

M1

M2

M2

← TO GILMAN
GILMAN SUBDIVISION

1" = 1800'
AUGUST 2015

TO FARMERSVILLE →
MP 85.00 - 90.00 PG 02 - 28

90 91 92 93 94 95

470+07 5280 5283 5280 5280 5279 734+09
 522+87 575+70 628+50 681+30

THAWVILLE
 91.2
 10,336 FT.

IROQUOIS CO.
 FORD CO.

TO MP 90.25 NO.15 SS

0.40 CIR 24" X 48'

0.60 CIR 24" X 42'

0.90 CIR 36" X 24'

0.90 CON 36" X 16'

0.40 CIR 36" X 48'

0.40 CIR 36" X 24'

0.80 CIR 12" X 48'

0.40 CIR 36" X 24'

TO MP 92.41 NO.15 SS

0.10 CIR 24" X 42'

0.10 VTC 24" X 6'

BR 93.80 - 42'
 DRAIN RCT

0.40 CIR 24" X 40'

BR 94.90 - 14'
 DRAIN ARCH

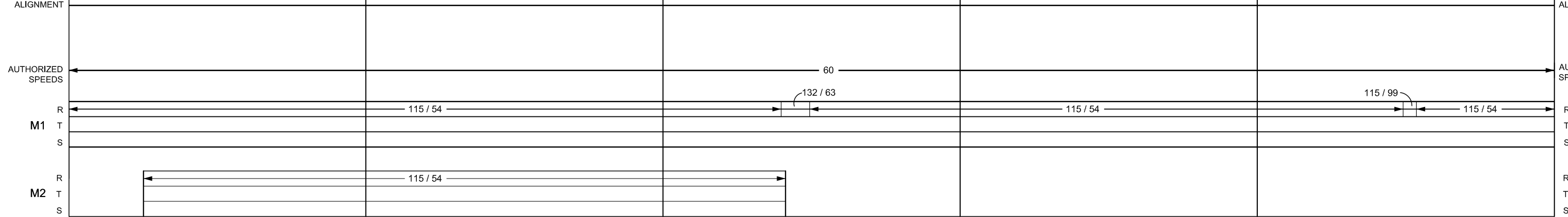
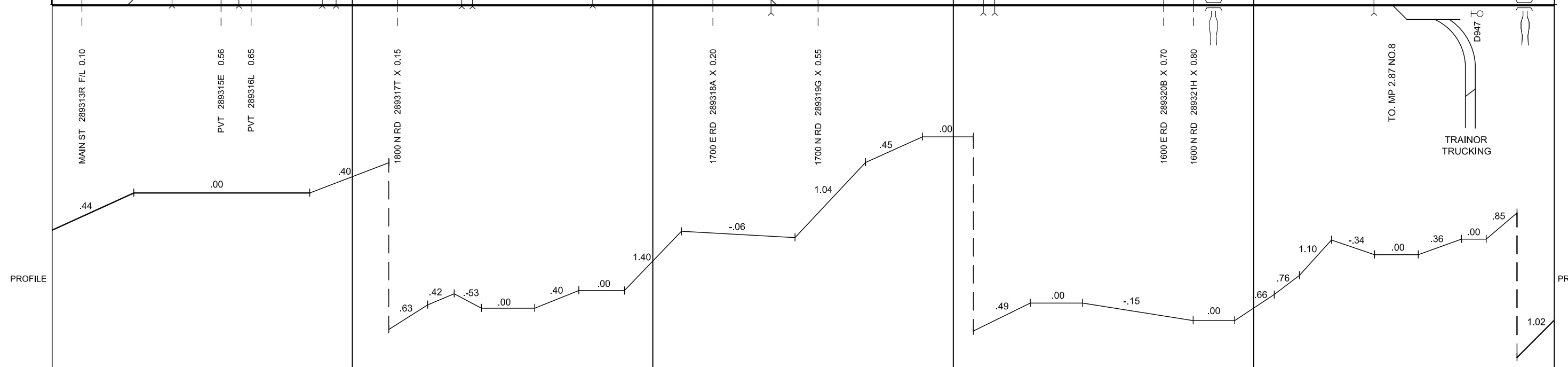

← TO GILMAN
 GILMAN SUBDIVISION

1" = 1800'
 AUGUST 2015

TO FARMERSVILLE
 MP 90.00 - 95.00

→ PG 03 - 28

95 96 97 98 99 100

734+09 5275 786+84 5286 899+70 5282 892+52 5281 945+33 5280 998+13

ROBERTS
95.6

TO MP 95.53 NO.10

IL RTE 115 289324D F/L 0.18

WELDON ST 289325K F/L 0.60
MAIN ST 289326S F/L 0.63
GREEN ST 289327Y F/L 0.70

0.60 CIR 36" X 24"

1400 E RD 289330G X 0.60
BUCKLEY RD -1400 N 289331N X 0.65

D969
D968

PVT 289332V 0.45

0.90 CIR 36" X 24"

BR 98.00 - 34'
WALL TOWN DRAINAGE PCX

0.10 CMP 36" X 24"
0.20 CMP 36" X 24"

1300 N RD 289334J X 0.15

0.50 CIR 36" X 24"

0.10 CON 60" X 42"
0.10 CON 60" X 24"

1200 E RD 289335R X 0.25

O O

1200 N 289336X F/L 0.70
TO MP 99.72 NO.12

FARM SERVICES

PROFILE

PROFILE

ALIGNMENT

ALIGNMENT

AUTHORIZED SPEEDS

AUTHORIZED SPEEDS

M1

M1

M2

M2

1 1/8"
.46
0'-57"
.67

112 CWR / 98 115 / 98 112 CWR / 98

115 / 54

132 CWR / 59 (GAS)

60

← TO GILMAN
GILMAN SUBDIVISION

1" = 1800'
AUGUST 2015

TO FARMERSVILLE →
MP 95.00 - 100.00 PG 04 - 28

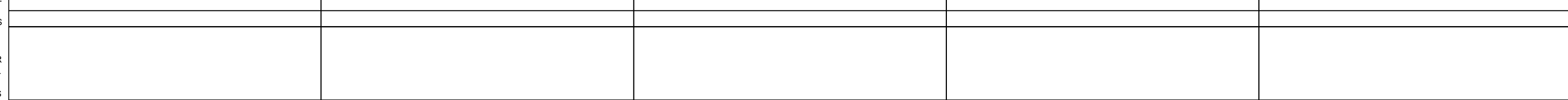
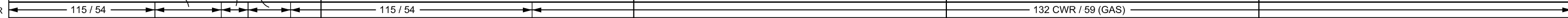

100 5284 101 5259 102 5300 103 5282 104 5278 105

998+13 1050+97 1103+56 1156+56 1209+38 1262+16

MELVIN
100.2

BR 100.00-8'
DRAIN ARCH

CON 24" X 0'
0.10

MAIN ST 289338L F/L 0.30

CENTER ST 289339T F/L 0.40

WEST ST 289340M F/L 0.60

PVT 289341U 0.85

1100 N RD 289342B X 0.20

0.70 CIR 24" X 60'

D1018
D1019

0.90 CIR 24" X 60'

PVT 289343H 0.75

BR 102.10-38'
ELLIOTT RD - 1000 E BMS
289344P

1000 N RD 289346D X 0.60

BR 102.80-60'
THE BIG FOUR DITCH TPG

0.30 CMP 60" X 36'

900 E RD 289347K X 0.50

BR 104.00-42'
DRAIN RCT

900 N RD 289348S X 0.00

0.60 CMP 30" X 30'

BR 104.70-42'
DRAIN RCT

D1048
D1049

800 E RD 289350T X 0.95

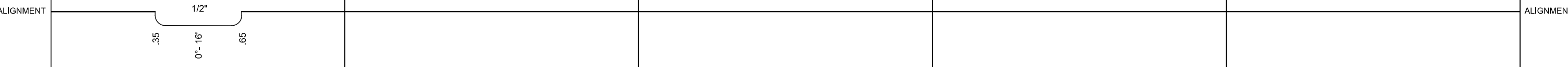
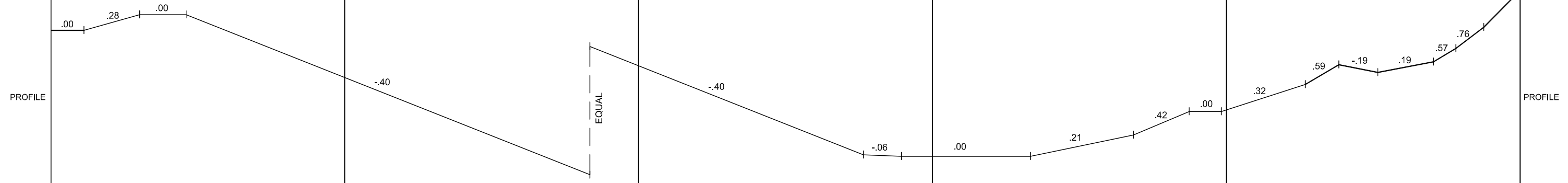

AUTHORIZED SPEEDS ← 60 → AUTHORIZED SPEEDS

M1 136 / 98 ← 132 CWR/59 (G) → 132 CWR / 59 (GAS) → M1

M2 M2

← TO GILMAN
GILMAN SUBDIVISION

1" = 1800'
AUGUST 2015

TO FARMERSVILLE →
MP 100.00 - 105.00 PG 05 - 28

105 106 107 108 109 110

1262+16 5283 1314+99 5522 1370+21 5035 1420+56 5287 1473+43 5275 1526+18

BR 105.70-16'
DRAIN CBX

0.50 CIR 36" X 24"
0.50 CON 36" X 16"

0.10 CIR 24" X 24"

0.60 CIR 24" X 48"

0.60 CIR 24" X 54"

BR 108.10-80'
DICKERSON SLOUGH PCS

0.50 CON 60" X 36"

LAWRENCE ST 289357R F/L 0.20
13TH ST 289358X F/L 0.60
12TH ST 289360Y F/L 0.70
CHURCH ST 289361F F/L 0.83
10TH ST 289362M F/L 0.92
SANGAMON AVE 289363U F/L 0.95

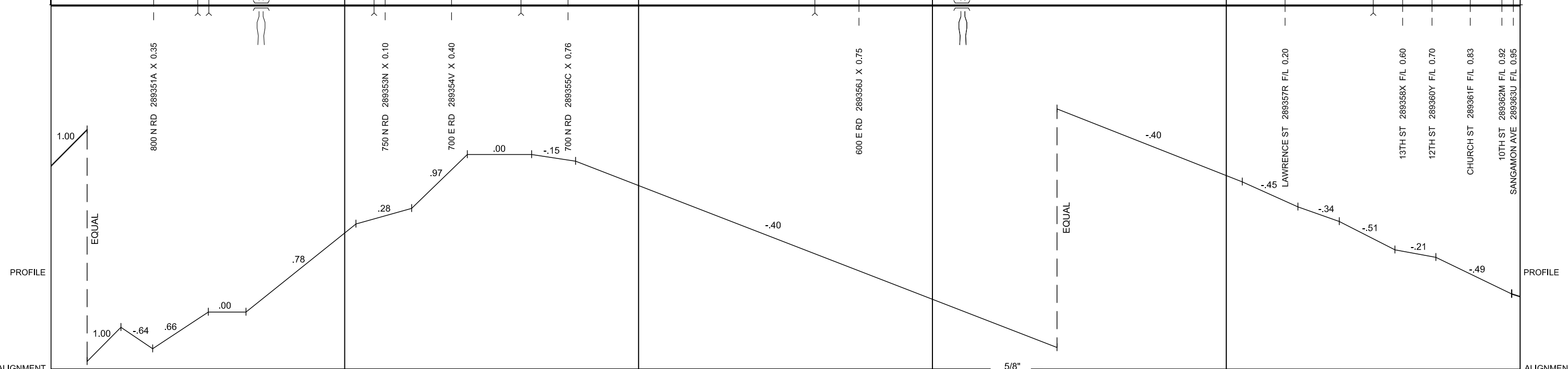

AUTHORIZED SPEEDS	60	25
M1	132 CWR / 59 (GAS)	132 / 57
M2		136 CWR / 98

← TO GILMAN
GILMAN SUBDIVISION

1" = 1800'
AUGUST 2015

TO FARMERSVILLE →
MP 105.00 - 110.00 PG 06 - 28

110 111 112 113 114 115

1526+18 5286 1579+04 5282 1631+86 5282 1684+68 5282 1737+50 5278 1790+28

GIBSON CITY
110.0
8,634 FT

BR 110.60 - 108'
DRUMMER CREEK RCT

BR 112.20 - 72'
DRUMMER CREEK PCG

BR 112.90 - 16'
DRAIN RCT

BR 114.10 - 56'
DRAIN RCT

BR 114.90 - 15'
DRAIN RCS

TO MP 110.10 NO.15
8TH ST 289365H F/L 0.20

TO MP 110.16 NO.10

TO MP 112.06 NO.15

300 N RD 289368D F/L/G 0.25

SAYBROOK RD E 200 N 289371L X 0.60

PVT 289373A 0.15

PVT 289374G 0.65

HARPSTER RD 289375N X 0.95

RR CROSSING MP	110.30
RR CROSSED	NS
MAINTAINED BY	CN
SECTION & WEIGHT	
CENTRAL ANGLE	47° 40' 00"
TYPE CROSSING	INTERLOCKING

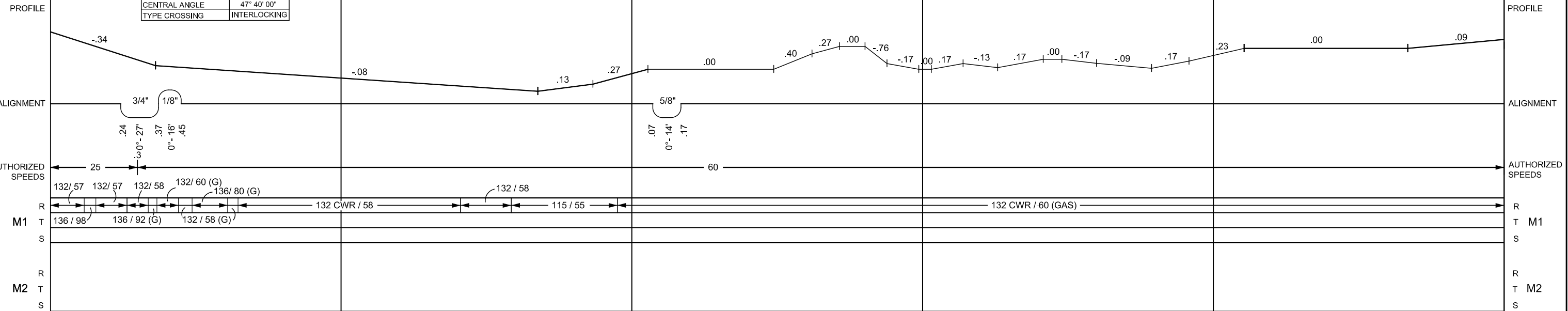

← TO GILMAN
GILMAN SUBDIVISION

1" = 1800'
AUGUST 2015

TO FARMERSVILLE
MP 110.00 - 115.00
PG 07 - 28 →

115 5272 116 5244 117 5320 118 5281 119 5298 120

1790+28 1843+00 1895+44 1948+64 2001+45 2054+43

FORD CO.
CHAMPAIGN CO.
BR 116.40 - 168'
SANGAMIAN RIVER RCT

CHAMPAIGN CO.
MCLEAN CO.

BR 118.80 - 42'
DRAIN RCT

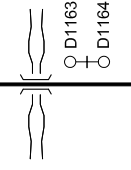

100 E RD 289376V X 0.20

50 N RD 289377C X 0.65

000 E RD 289379R X 0.61

750 N RD 289380K X 0.00

4100 E RD 289381S X 0.10

PVT 289382Y 0.50

600 N RD 289383F X 0.05

4000 E RD 289384M X 0.60

PVT 289385U 0.00

0.90 CIR 24" X 24'

0.20 CIR 36" X 24'

0.80 CON 96" X 14'

0.10 CIR 36" X 24'

0.70 CON 36" X 40'
0.70 CON 36" X 16'

PROFILE

.09 .17 .38 .00 .21 .00 .04 .32 .00 .21 .00 .53 .13 .02

ALIGNMENT

AUTHORIZED SPEEDS

60

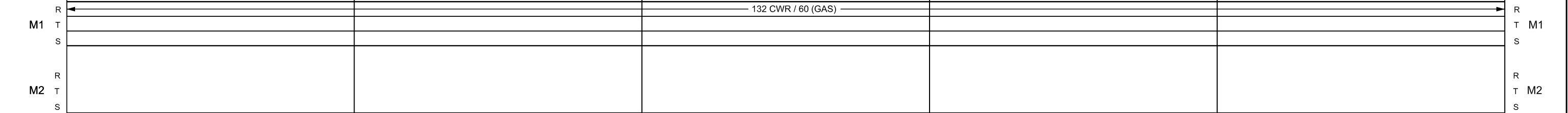

1" = 1800'
AUGUST 2015

← TO GILMAN
GILMAN SUBDIVISION

TO FARMERSVILLE →
MP 115.00 - 120.00 PG 08 - 28

120 121 122 123 124 125

2054+43 5265 2107+08 5281 2159+89 5277 2212+66 5274 2265+40 5286 2318+26

BELLFLOWER
121.8

BR 120.70 - 32'
DRAIN RCS

BR 123.40 - 74'
DRAIN PCT

0.10 CON 36" X 40"
0.10 CIR 36" X 24'

0.30 CMP 36" X 30'

0.80 CON 36" X 56'

0.90 CIR 48" X 48'

0.60 CIR 48" X 30'

0.80 CIR 24" X 36'

500 N RD 289386B X 0.45

MELVIN ST 289388P F/L 0.70

STATE ST 289389W F/L 0.90

PVT 289390R 0.50

PVT 289391X 0.00

US 136 289393L F/L 0.60

PROFILE

PROFILE

ALIGNMENT

ALIGNMENT

AUTHORIZED SPEEDS

AUTHORIZED SPEEDS

M1

M1

M2

M2

132 CWR / 84 (GAS) 132 CWR / 60 (GAS) 132 CWR / 60 (GAS) 115 / 97 (GAS) 115 CWR / 68 (GAS)

← TO GILMAN
GILMAN SUBDIVISION

1" = 1800'
AUGUST 2015

TO FARMERSVILLE →
MP 120.00 - 125.00 PG 09 - 28

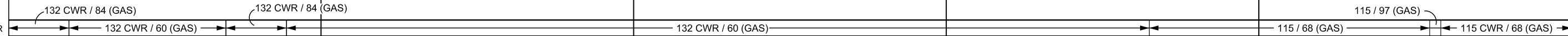
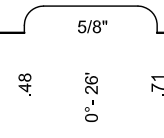
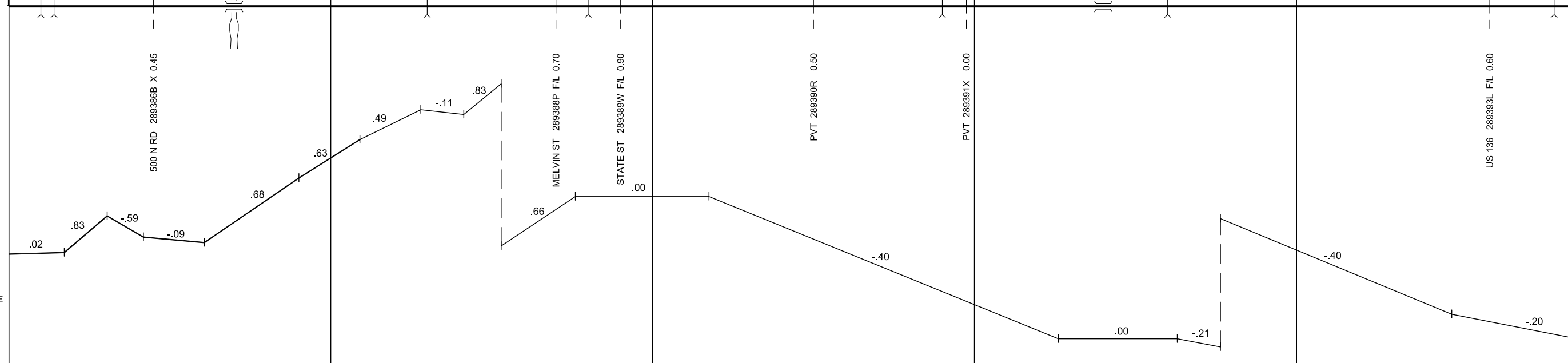

125 126 127 128 129 130

2318+26 5282 2371+08 5282 2423+90 5285 2476+75 5281 2529+56 5274 2582+30

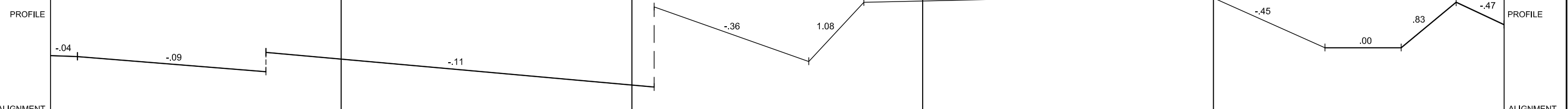
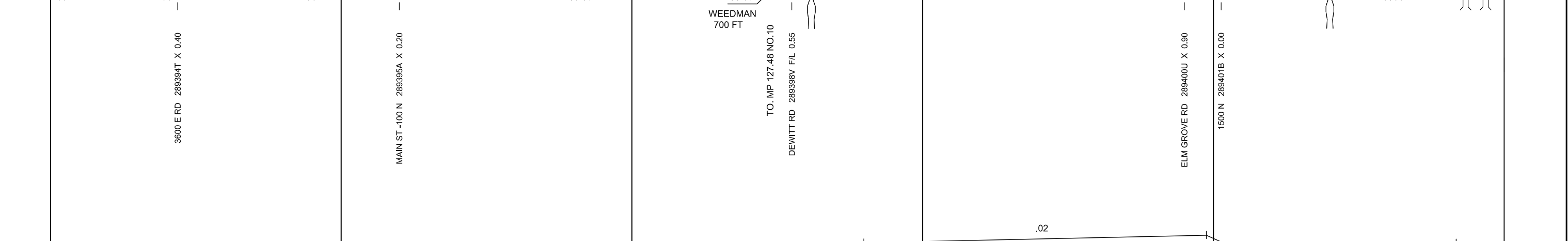
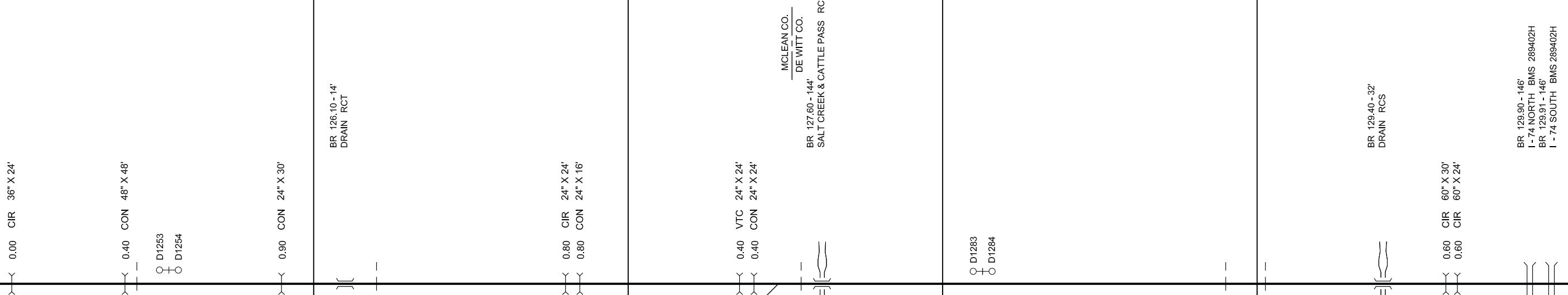

AUTHORIZED SPEEDS	50		AUTHORIZED SPEEDS
M1	115 CWR / 68 (GAS)		M1
M2			M2

← TO GILMAN GILMAN SUBDIVISION 1" = 1800' AUGUST 2015 TO FARMERSVILLE MP 125.00 - 130.00 PG 10 - 28 →

130

131

132

133

134

135

2582+30

2635+11

2687+90

2740+71

2793+54

2846+36

FARMER CITY
130.6
6,011 FT

BR 130.90 - 32'
DRAIN RCT

BR 132.20 - 42'
DRAIN RCT

BR 133.40 - 16'
CREEK RCT

0.10 CIR 12" X 24'

MAIN ST 289404W X 0.40

US 150 & PLUM ST 289405D F/L/G 0.50

JOHN ST 289408K F/L 0.60

TO, MP 130.67 NO.10

CHESTNUT RD 289408Y X 0.55

DUPONT RD 289409F X 0.94

PVT 289410A 0.95

ROSEWOOD RD 289411G X 0.25

PARNELL RD 289412N F/L 0.80

0.70 CMP 24" X 24'

0.70 CMP 24" X 24'

0.00 CIR 24" X 24'

0.20 CMP 36" X 36'

0.80 CMP 36" X 24'

0.20 CIR 24" X 24'

0.20 CIR 24" X 24'

0.80 CIR 16" X 12'

0.80 CIR 16" X 36'

0.90 CMP 36" X 30'

0.90 CMP 36" X 30'

PROFILE

PROFILE

ALIGNMENT

ALIGNMENT

AUTHORIZED SPEEDS

AUTHORIZED SPEEDS

M1

M1

M2

M2

← TO GILMAN
GILMAN SUBDIVISION

1" = 1800'
AUGUST 2015

TO FARMERSVILLE
MP 130.00 - 135.00
PG 11 - 28

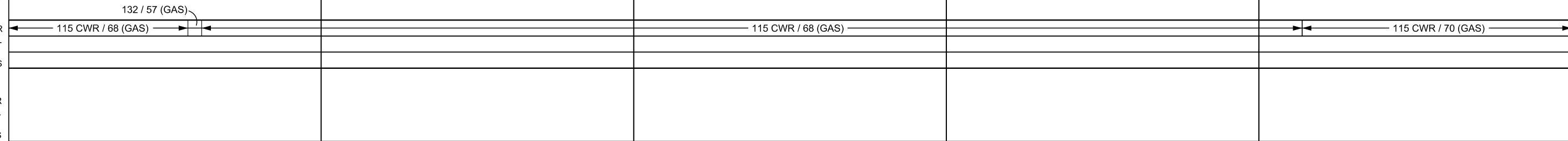
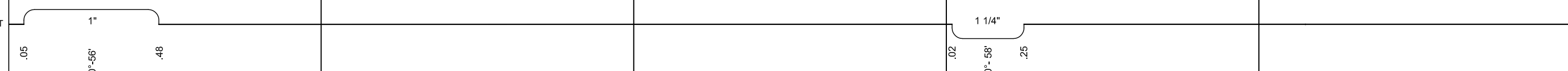
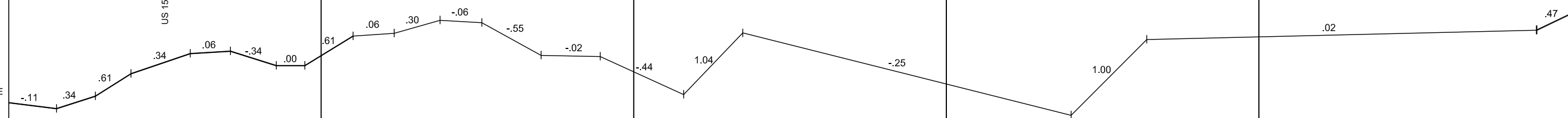

135

136

137

138

139

140

2846+36

2899+16

2952+01

3004+84

3057+67

3110+49

5280

5285

5283

5283

5282

FULLERTON
136.6

BR 136.30 - 32'
DRAIN RCS

BR 137.90 - 12'
DRAIN CBX

BR 138.40 - 14'
DRAIN RCT

BR 139.00 - 14'
DRAIN RCT

BR 139.60 - 28'
DRAIN PCG

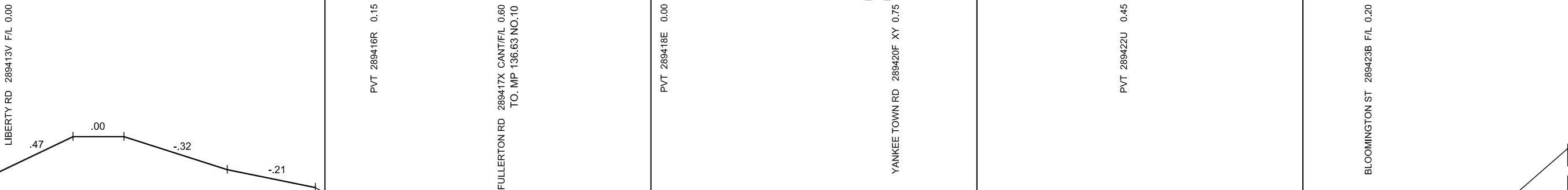
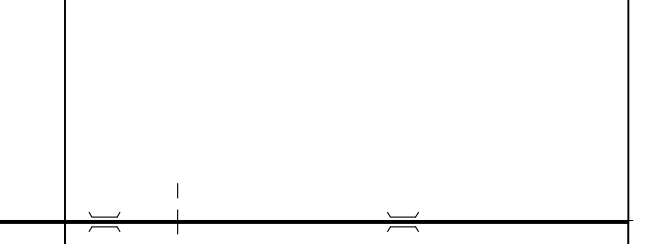
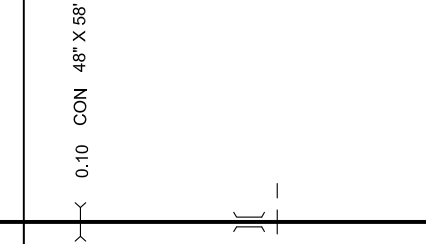
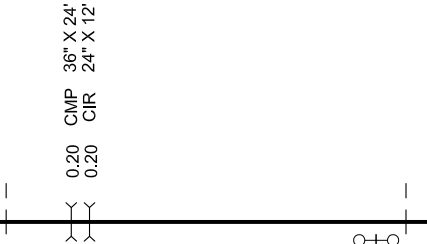
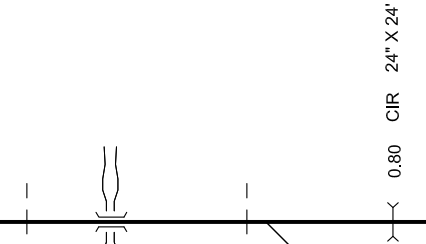
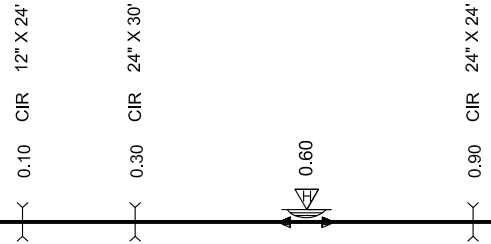

PROFILE

PROFILE

ALIGNMENT

ALIGNMENT

AUTHORIZED SPEEDS

AUTHORIZED SPEEDS

M1
R
T
S

M1
R
T
S

M2
R
T
S

M2
R
T
S

← TO GILMAN
GILMAN SUBDIVISION

1" = 1800'
AUGUST 2015

TO FARMERSVILLE →
MP 135.00 - 140.00 PG 12 - 28

115 CWR / 70 (GAS)

132 CWR / 59 (GAS)

140 5284 141 5281 142 5280 143 5285 144 5254 145

3110+49 3163+33 3216+14 3268+94 3321+79 3374+33

D1402
D1403

TO MP 141.27 NO.10

ILLINOIS POWER

BR 142.16 - 147
GOOSE CREEK TIM
BR 142.30 - 50'
SALT CREEK - LAKE ARCH

BR 143.33 - 12'
RD CBX

HEARTLAND RD 289424H XY 0.05

PVT 289425P 0.80

PVT 289426W 0.20

POWER RD 289427D F/L 0.60

SESAME RD 289429S F/L 0.70

BIRKBECK RD 1450 E 289430L F/L 0.66

TOWN HALL RD 289431T XY 0.20

MULBERRY RD 289432A XY 0.00

PROFILE

PROFILE

ALIGNMENT

ALIGNMENT

AUTHORIZED SPEEDS

AUTHORIZED SPEEDS

M1

M1

M2

M2

← TO GILMAN
GILMAN SUBDIVISION

1" = 1800'
AUGUST 2015

TO FARMERSVILLE →
MP 140.00 - 145.00 PG 13 - 28

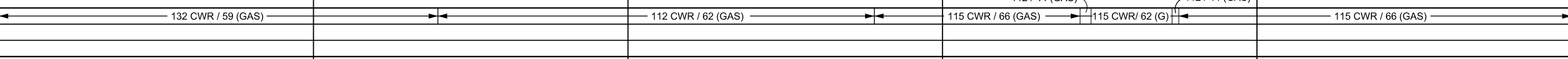
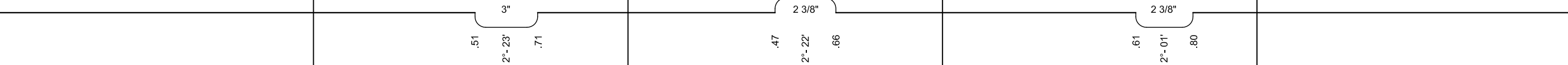
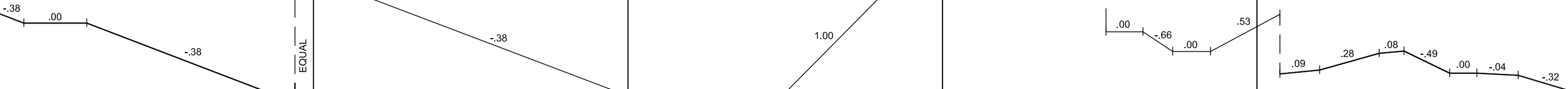

145 146 147 148 149 150

3374+33 5308 3427+41 5283 3480+24 5280 51+10 5057 101+67 5282 154+49

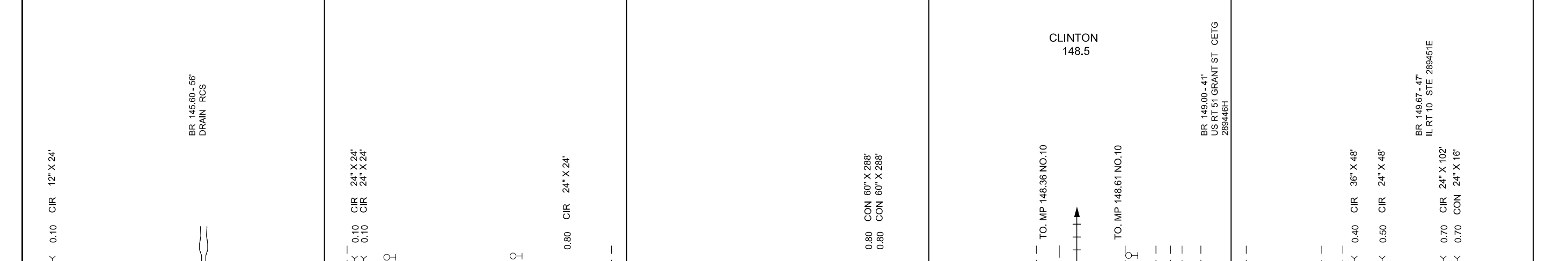

RR CROSSING MP	148.5
RR CROSSED	SOUTH IND. LINE
MAINTAINED BY	CN
SECTION & WEIGHT	
CENTRAL ANGLE	90° 00' 00"
TYPE CROSSING	INTERLOCKING

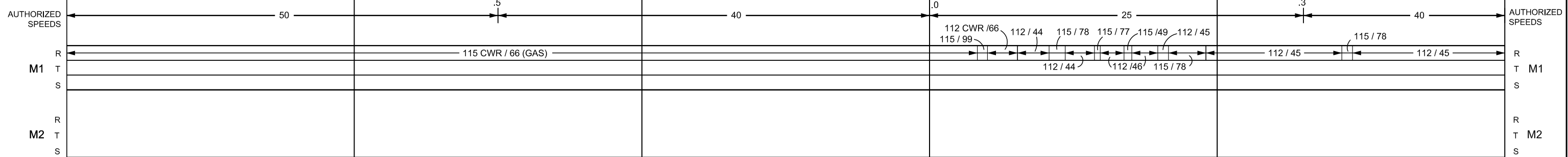
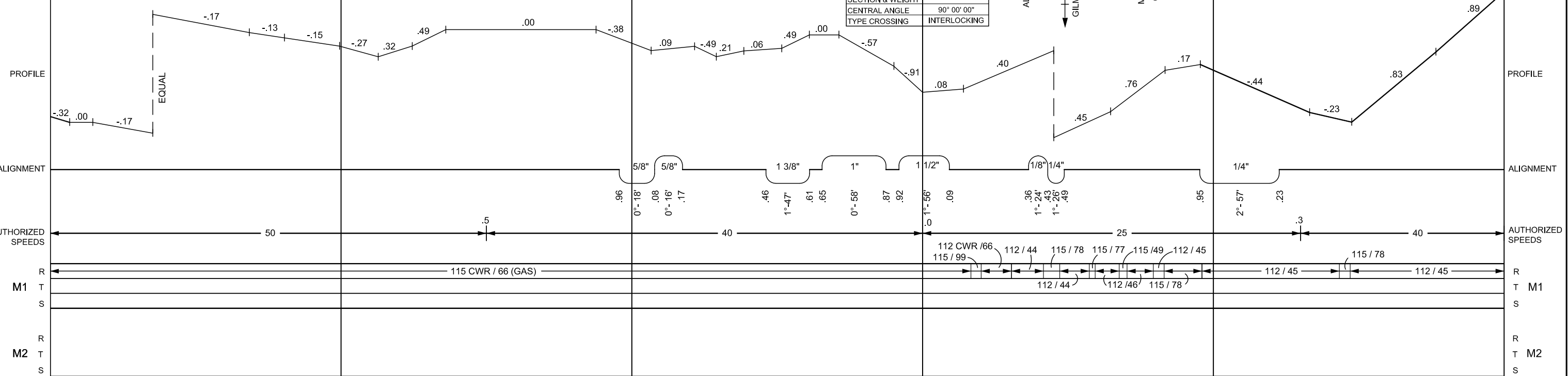

← TO GILMAN
GILMAN SUBDIVISION

1" = 1800'
AUGUST 2015

TO FARMERSVILLE →
MP 145.00 - 150.00 PG 14 - 28

150 151 152 153 154 155

154+49 5280 207+29 5210 259+39 5303 312+42 5263 365+05 5369 418+74

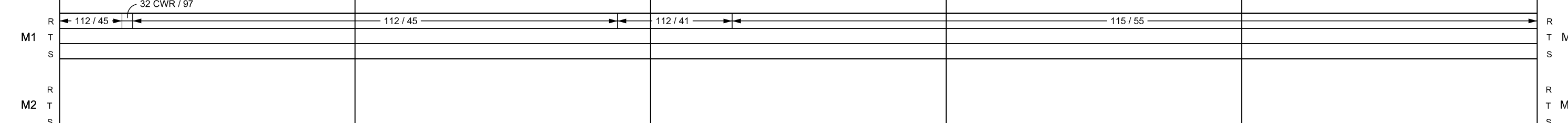
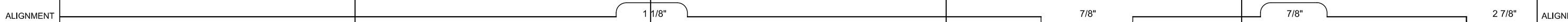
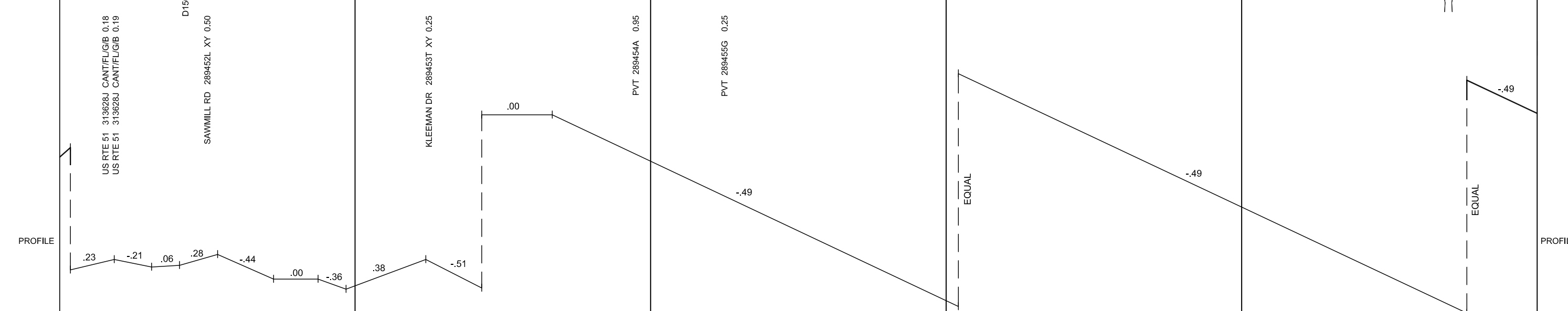
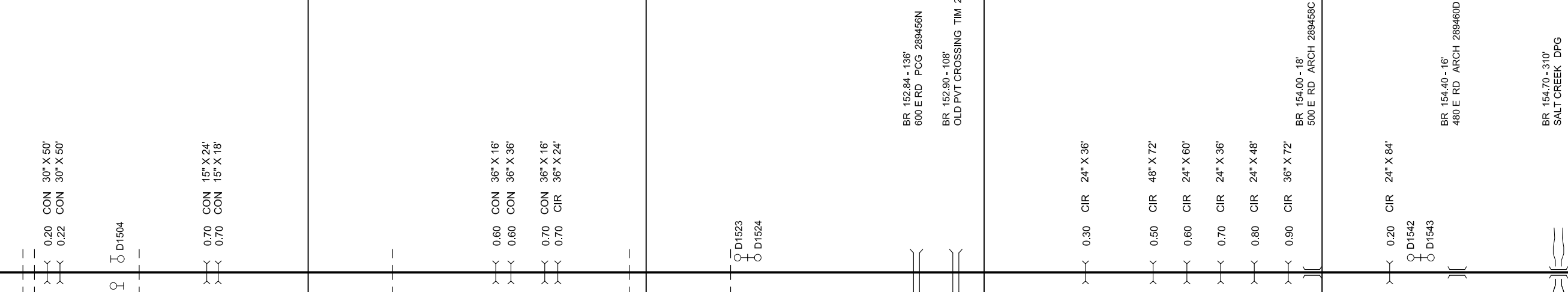

155 156 157 158 159 160

418+74 5287 471+61 5264 524+25 5283 577+08 5281 629+89 5285 682+74

BR 155.31 - 16'
TURNBRIDGE RD ARCH 289461K

0.39 CON 30" X 84'

0.60 CIR 36" X 84'

471+61 0.00 CIR 24" X 36'

BR 156.20 - 12'
SALT CREEK BRANCH ARCH

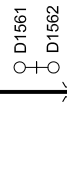

KENNEY
156.7

TO. MP 157.03 NO.10

0.20 CIR 24" X 24'

0.20 CIR 24" X 24'

SOUTH CREEK RD 289470J XY 0.25

577+08 0.00 CIR 12" X 24'

S. KENNEY
156.7



629+89 0.00 CON 24" X 32'

PLEASANT VALLEY RD 289471R XY 0.00

PVT 289472X 0.20

0.30 CIR 36" X 24'

0.50 CIR 36" X 24'

0.80 CON 48" X 24'

682+74 0.00 CIR 24" X 24'

PVT 289473E 0.95

PROFILE

ALIGNMENT

AUTHORIZED SPEEDS

M1

M2

PROFILE

ALIGNMENT

AUTHORIZED SPEEDS

M1

M2

-.49

.21

.98

.53

-.09

-.30

-.09

-.19

-.08

-.13

.28

-.47

.00

.06

.30

2 7/8"

.21

.30

2"

1°-57'

.60

.38

3/4"

0°-57'

.66

40

115 / 55

112 / 39

115 / 54

115 / 52

← TO GILMAN
GILMAN SUBDIVISION

1" = 1800'
AUGUST 2015

TO FARMERSVILLE →
MP 155.00 - 160.00 PG 16 - 28

160 161 162 163 164 165

682+74 5276 735+50 5348 788+98 5214 841+12 5305 894+17 5251 946+68

DEWITT CO.
LOGAN CO.

0.30 CMP 30" X 24"
D1606
D1607

MERIDIAN RD 289474L XY 0.30

0.00 CIR 12" X 24"

2300 AVE 289475T XY 0.47

0.70 CIR 30" X 50"

0.60 CIR 36" X 24"

TO. MP 162.60 NO.10
LOGAN ST 289476A F/L 0.60
DAUPHIN 289477G F/L 0.70

CHESTNUT
2,209 FT

0.20 CMP 36" X 50"

TO. MP 163.06 NO.10

PVT 289478N 0.55

0.50 CIR 36" X 24"

D1646
D1647

2000 AVE 289480P X 0.85

0.90 CIR 24" X 24"

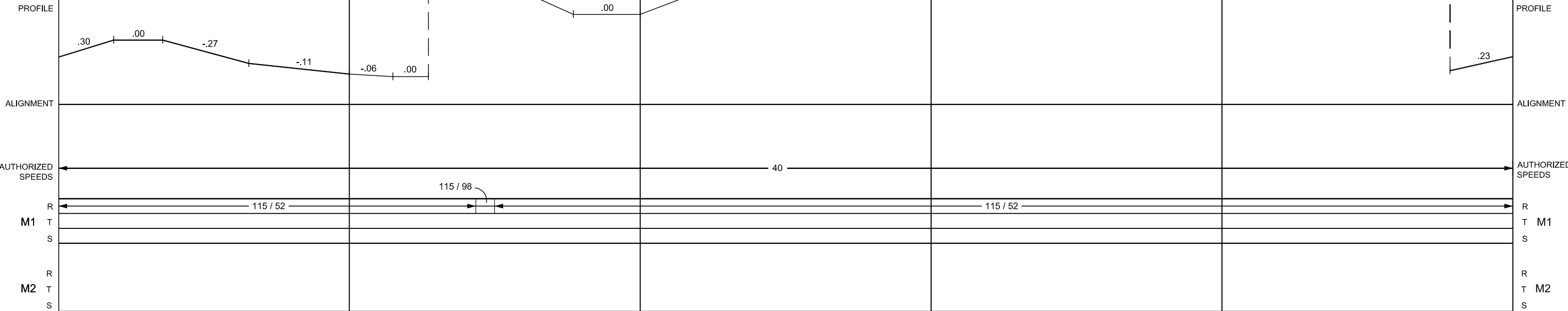

1" = 1800'
AUGUST 2015

PG 17 - 28

165 166 167 168 169 170

946+68 5282 999+50 5277 1052+27 5279 1105+06 5278 1157+84 5278 1210+62

N. MT PULASKI
166.7
9,049 FT

BR 167.30 - 15'
DRAIN TIM

BR 168.52 - 48'
TOPPER DR IL RTE #121 CETG
289487M

MT. PULASKI
169.0

BR 169.20 - 20'
SPRING ST ARCH
289496L

0.40 CIR 24" X 24'

0.60 CIR 24" X 42'

0.20 CIR 24" X 24'

0.80 CIR 24" X 24'

TO. MP 167.84 NO.10

TO. MP 168.52 NO.10 SS

0.70 CIR 24" X 36'
0.70 VTC 24" X 28'
0.76 CIR 24" X 48'
0.76 VTS 24" X 48'
0.80 CON 12" X 34'

0.90 CON 24" X 16'
0.90 CIR 24" X 96'

TO. MP 169.09 NO.10

0.90 CIR 48" X 30'

800 ST 289481W X 0.40

1913TH AVE 289482D X 0.80

PVT 289483K 0.35

TO. MP 166.58 NO.15

1800TH AVE 289484S X 0.05

700TH ST 289485Y F/L/G 0.25

PVT ????? 0.74

TO. MP 168.50 NO.15

VINE ST 289489B F/L 0.85

ILLINOIS ST 289495E F/L 0.00

TO PEORIA
PEORIA SUB

PROFILE

ALIGNMENT

AUTHORIZED SPEEDS

M1
T
S
M2
T
S

PROFILE

ALIGNMENT

AUTHORIZED SPEEDS

M1
T
S
M2
T
S

RR CROSSING MP	169.2
RR CROSSED	CN
MAINTAINED BY	CN
SECTION & WEIGHT	136
CENTRAL ANGLE	60° 32' 30"
TYPE CROSSING	SOLID MANG.

← TO GILMAN
GILMAN SUBDIVISION

1" = 1800'
AUGUST 2015

TO FARMERSVILLE
MP 165.00 - 170.00
PG 18 - 28 →

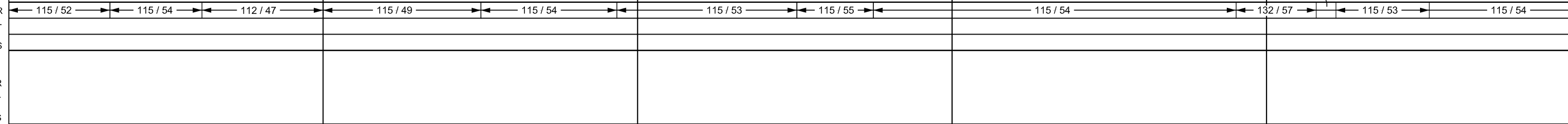
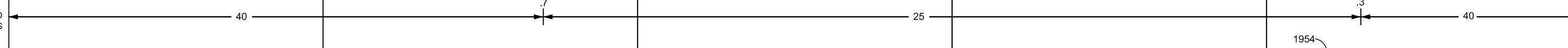

170 5285 171 5280 172 5281 173 5279 174 5280 175

1210+62 1263+47 1316+27 1369+08 1421+87 1474+67

LAKE FORK
173.2
6,493 FT

TO. MP 173.20 NO.15 SS

TO. MP 174.62 NO.15 SS

CON 48" X 42"
CON 48" X 36"

CIR 36" X 30'

CIR 24" X 24'

CIR 12" X 24'

CIR 24" X 24'
CMP 24" X 3'

CIR 24" X 24'

1500 AVE 295541S X 0.80

1400 AVE 295542Y X 0.90

PRIME RD 1300TH AVE 295543F CANT/IFL 0.05

1225TH AVE 295544M XY 0.00

PVT 295545U 0.30

LAKE FORK FERTILIZER
TO. MP 173.68 NO.10

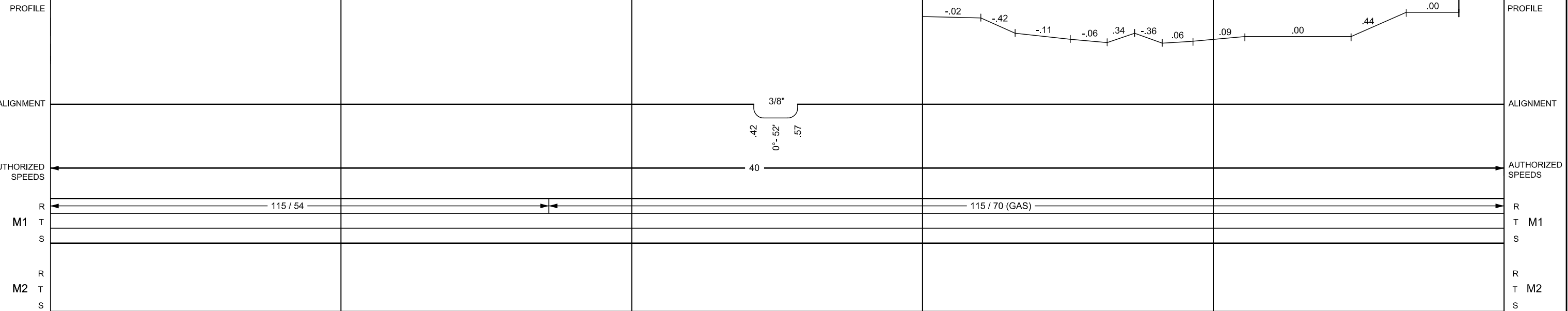

← TO GILMAN
GILMAN SUBDIVISION

1" = 1800'
AUGUST 2015

TO FARMERSVILLE →
MP 170.00 - 175.00 PG 19 - 28

175 176 177 178 179 180

1474+67 1527+47 1580+31 1633+09 1685+80 1738+54

BR 175.40 - 352'
LAKE FORK CREEK RCT

5280

0.30 CIR 24" X 24'

5284

0.50 CON 24" X 48'

0.80 CIR 12" X 36'

177

1580+31

0.10 CMP 30" X 36'

0.20 CIR 36" X 24'

LOGAN CO.
SANGAMON CO.

BR 177.30 - 32'
DRAIN RCT

5278

BR 177.50 - 16'
DRAIN RCS

178

1633+09

5271

0.50 CIR 48" X 24'

PVT 295561D 0.50

179

1685+80

D1792
D1793

0.30 CIR 24" X 12'

0.30 CIR 24" X 36'

0.50 CIR 24" X 78'

5274

MEASURED MILE

180

1738+54

BUFFALO HART RD/ CR 16 295563S F/L 0.80

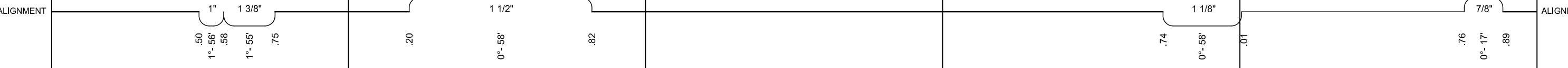
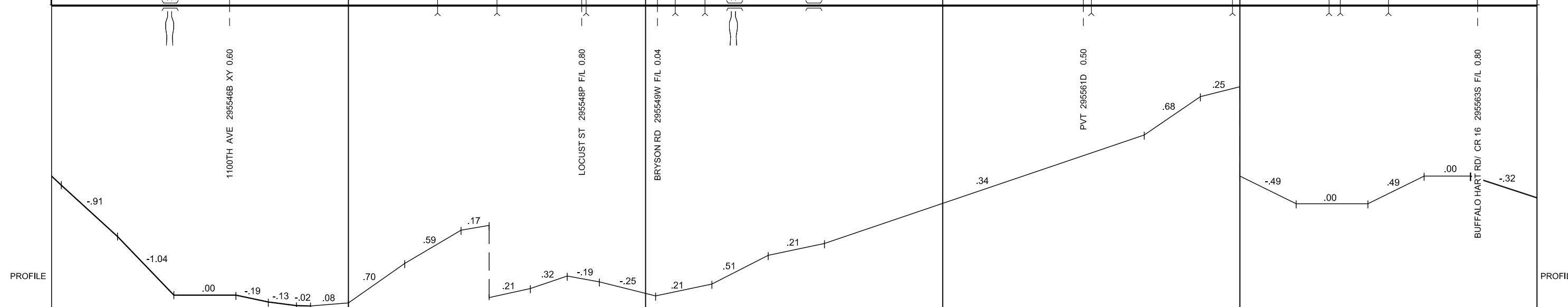

AUTHORIZED SPEEDS 40

R 115 CWR / 70 (GAS) 112 / 43(G) 115 CWR / 70 (GAS) 112 / 44(G) 115 CWR / 70 (G)

M1 T M1

R T M2

S T M2

← TO GILMAN
GILMAN SUBDIVISION

1" = 1800'
AUGUST 2015

TO FARMERSVILLE →
MP 175.00 - 180.00 PG 20 - 28

180 181 182 183 184 185

1738+54 5294 1791+48 5281 1844+29 5278 1897+07 5280 1949+87 5281 2002+68

BR 180.00 - 14'
RD & CATTLE PASS ARCH
BR 180.01 - 8'
DRAIN ARCH

BR 181.50 - 16'
DRAIN & CATTLE CROSSING ARCH

BR 182.20 - 14'
CATTLE PASS ARCH

BR 182.40 - 14'
DRAIN ARCH

BR 182.70 - 60'
DRAIN & PRAIRIE SCHOOL RD ARCH
295568B

BR 183.00 - 8'
DRAIN ARCH

BR 184.03 - 14'
DRAIN ARCH

BR 184.50 - 14'
DRAIN ARCH

BR 184.80 - 10'
DRAIN ARCH

UNIK 60" X 96"

CIR 36" X 45'
VTC 15" X 15'

CON 24" X 16'
CIR 24" X 36'

D1837
D1838

TO MP 184.24 NO.10
CIR 12" X 72'

BARCLAY
500 FT

HIGH MEADOW 295573X F/L/G 0.87

CASS RD 295565F X 0.85

SHERMAN RD 295566M F/L 0.60

PVT 295567U 0.30

PVT BROWN'S XING 295569H 0.07

PVT UNK _ 0.71

BARLOW RD 295571J F/L/G 0.23

PROFILE

ALIGNMENT

AUTHORIZED SPEEDS

M1

M2

PROFILE

ALIGNMENT

AUTHORIZED SPEEDS

M1

M2

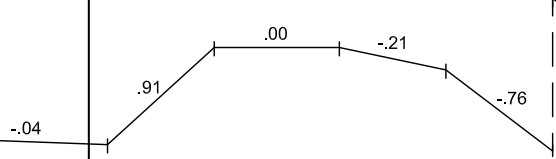
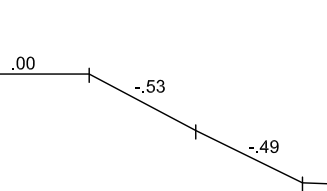
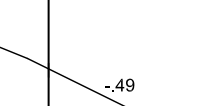
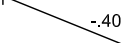
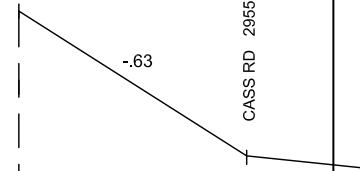
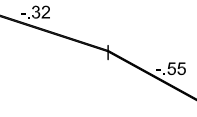

3/4"
0'-58"

115 CWR / 70 (GAS)

112 CWR / 70 (GAS)

112 / 47(G)

112 CWR / 70 (GAS)

← TO GILMAN
GILMAN SUBDIVISION

1" = 1800'
AUGUST 2015

TO FARMERSVILLE
MP 180.00 - 185.00

PG 21 - 28

185 5413 186 5144 187 5276 188 5286 189 5280 190

2002+68 2056+81 2108+25 2161+01 2213+87 2266+67

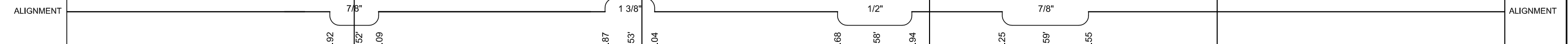
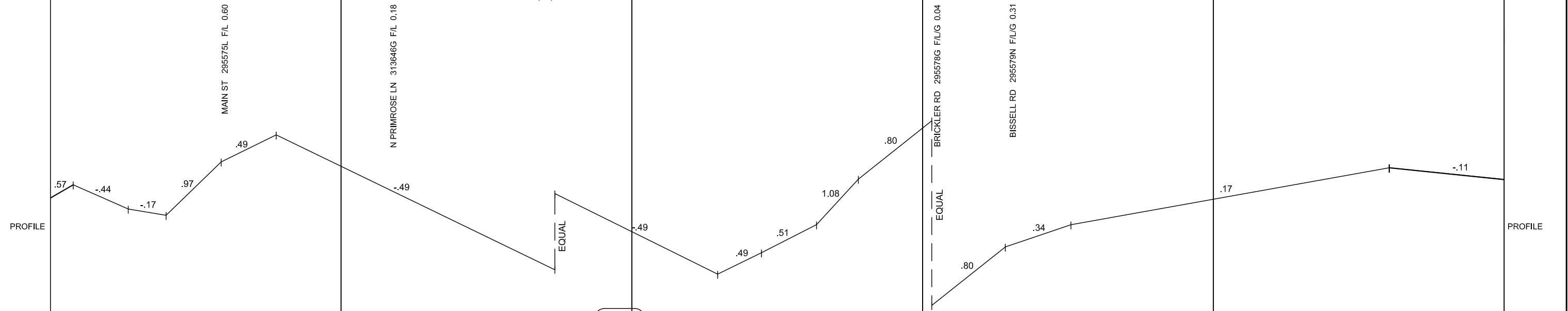
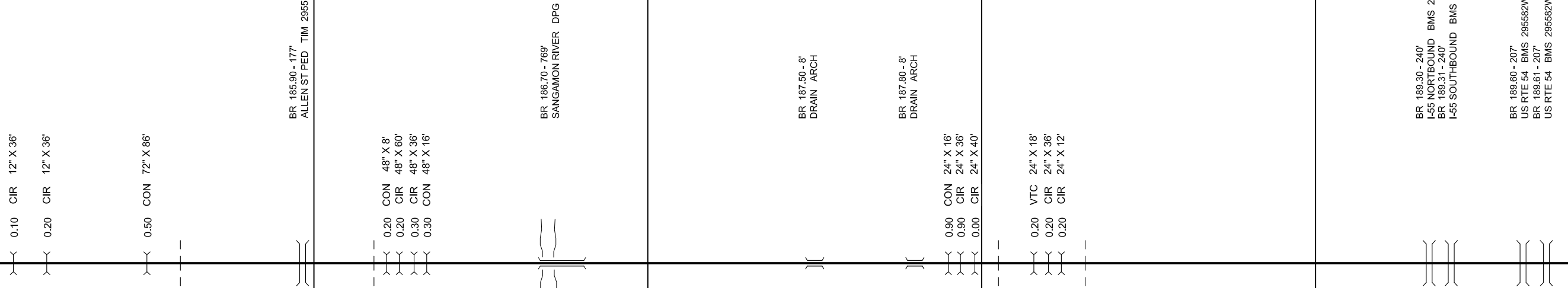

AUTHORIZED SPEEDS 40 112 CWR / 70 (GAS) 115 / 65 (G) 112 CWR / 70 (GAS) 112 / 45 (G) 112 CWR / 70 (GAS) 0

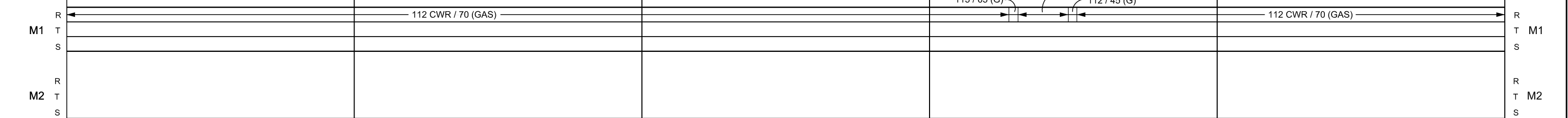

190 191 192 193 194 195

2266+67 5280 2319+47 5275 2372+22 5280 103+62 5370 157+32 5276 210+08

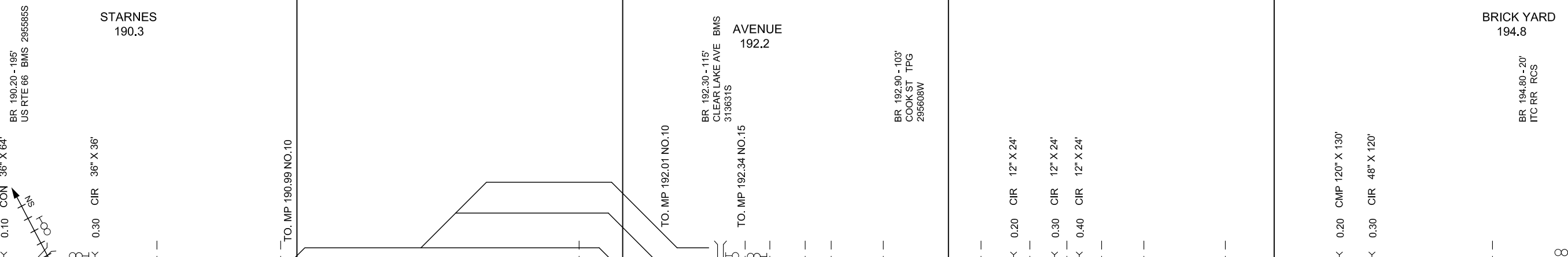

RR CROSSING MP	190.3
RR CROSSED	NS
MAINTAINED BY	CN
SECTION & WEIGHT	136
CENTRAL ANGLE	32° 22' 00"
TYPE CROSSING	RVR. MANG.

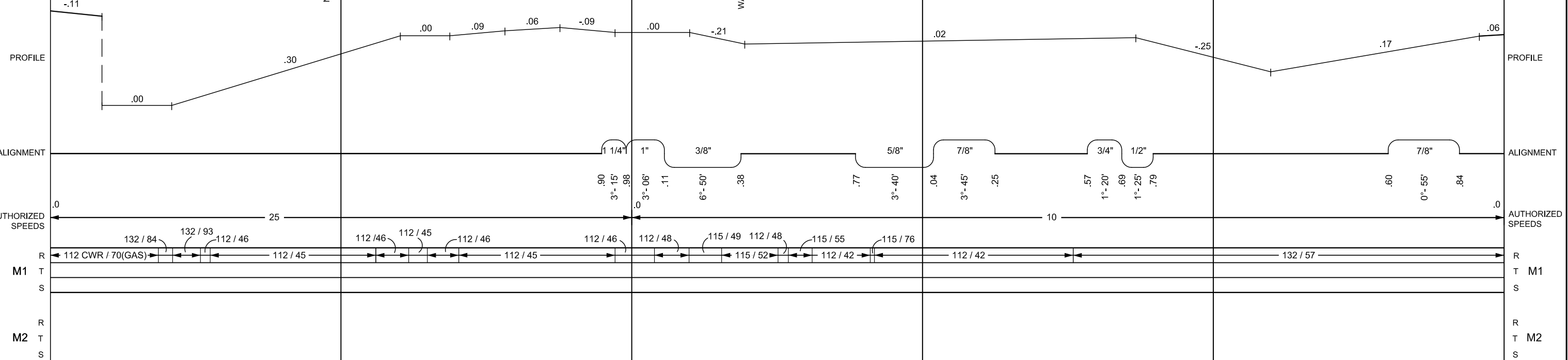

← TO GILMAN
GILMAN SUBDIVISION

1" = 1800'
AUGUST 2015

TO FARMERSVILLE →
MP 190.00 - 195.00 PG 23 - 28

195 196 197 198 199 200

210+08 5283 262+91 5262 315+53 5298 368+51 5282 421+33 5285 474+18

BR 195.40 - 112'
STEVENSON DR CEIB
295617V

TO MP 195.46 NO.8

LAKE
SPRINGFIELD
SPUR

TO MP 195.55 NO.10

0.10 CIR 48" X 96'

BR 196.30 - 204'
RTE L55 & 36 TPG
295619J

0.40 CIR 36" X 96'

BR 196.50 - 26'
HAZEL DEL RD CEIB
295626U

0.70 CIR 24" X 24'

11TH ST 313652K CANT/FL/G 0.99

0.10 CIR 24" X 48'

0.30 CIR 24" X 48'

TORONTO RD 295627B CANT/FL/G 0.45

BR 198.80 - 14'
DRIAN ARCH

0.00 CON 36" X 48'

0.20 CON 36" X 48'

0.40 CON 36" X 48'

BR 199.50 - 50'
DRAIN TPG

BR 199.70 - 320'
LAKE SPRINGFIELD DPG

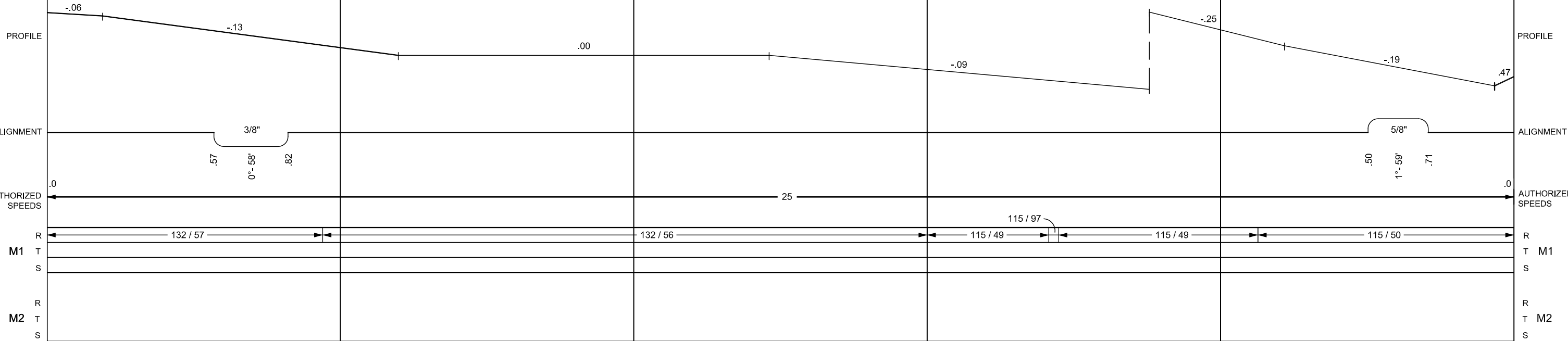

← TO GILMAN
GILMAN SUBDIVISION

1" = 1800'
AUGUST 2015

TO FARMERSVILLE →
MP 195.00 - 200.00 PG 24 - 28

200

201

202

203

204

205

474+18

527+00

579+80

632+60

685+40

738+22

5282

5280

5280

5280

5282

BR 200.10 - 130'
EAST LAKE DRIVE BMS
295628H

0.50 REC 24" X 75'
0.50 CIR 24" X 72'

BR 200.70 - 26'
STOUT DR BMS
295629P

0.71 CON 60" X 45'

PVT 295630J 0.90

0.50 CIR 24" X 24'

NEW CITY RD 295631R F/L 0.60

0.60 CON 48" X 48'

0.10 CON 24" X 40'

PULLIAM RD 295632X XY 0.10

PVT 295633E 0.20

0.70 CON 24" X 48'

PVT 295634L 0.90

PVT 295635T 0.10

BR 204.40 - 224'
I-55 NB BMS 295636A
BR 204.40 - 224'
I-55 SB BMS 295636A
BR 204.50 - 275'
PALM RD / US RTE 66 BMS

0.51 CIR 24" X 54'

GLENARM RD 295637G F/L 0.70

0.90 CIR 48" X 60'

PROFILE

PROFILE

ALIGNMENT

ALIGNMENT

AUTHORIZED SPEEDS

AUTHORIZED SPEEDS

M1

M1

M2

M2

.47

.30

.15

-.15

.15

-.09

.02

.11

5/8"
0° - 56'

7/8"
0° - 58'

.0

10

115 / 50

132 / 53

132 / 54

132 / 53

132 / 54

132 / 53

← TO GILMAN
GILMAN SUBDIVISION

1" = 1800'
AUGUST 2015

TO FARMERSVILLE →
MP 200.00 - 205.00 PG 25 - 28

205 206 207 208 209 210

738+22 5280 791+02 5290 843+92 5276 896+68 5280 949+48 5282 1002+30

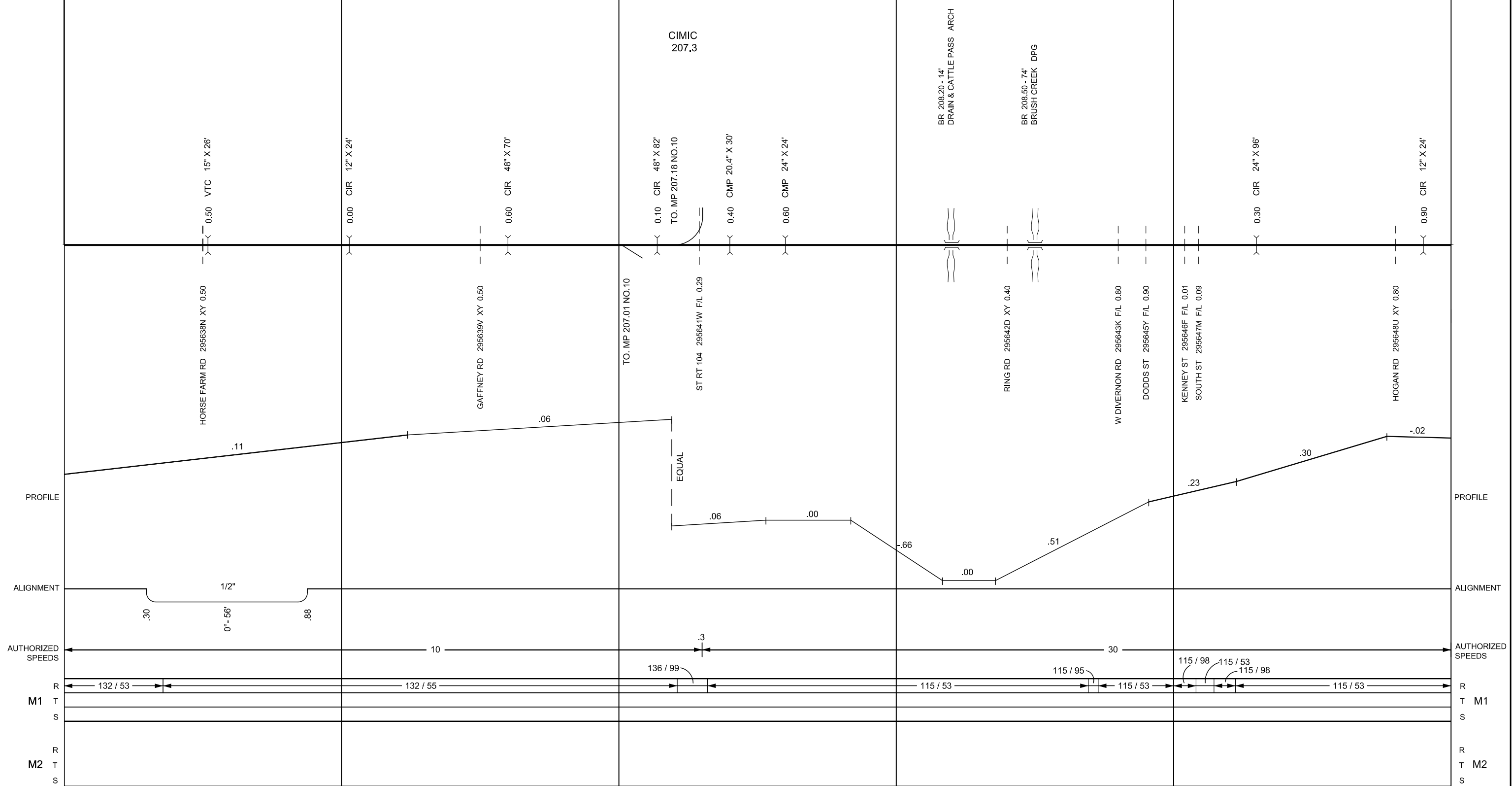

← TO GILMAN
GILMAN SUBDIVISION

1" = 1800'
AUGUST 2015

TO FARMERSVILLE →
MP 205.00 - 210.00 PG 26 - 28

210

211

212

213

214

215

1002+30

1055+12

1107+95

1160+76

1213+56

1266+37

5282

5283

5281

5280

5281

0.20 CIR 24" X 24'

0.50 CIR 36" X 36'

0.80 CIR 36" X 24'

0.20 CIR 24" X 24'

0.60 CIR 12" X 24'

0.80 CIR 12" X 24'

0.00 CIR 12" X 24'

0.40 CIR 48" X 24'

0.30 CIR 12" X 24'

0.50 CIR 12" X 24'

0.10 CIR 24" X 54'

BR 214.50 - 16' DRAIN RCS

SANGAMON CO.
MONTGOMERY CO.

BOARMAN RD W 295649B XY 0.80

MONTGOMERY RD 295650V XY 0.80

BR 213.10 - 42' DRAIN RCT

VIRDEN AVE 295656L XY 0.34

THOMASVILLE
849 FT

THOMASVILLE TR 295657T XY 0.23

N 33RD AVE 295658A XY 0.85

-02

.34

.04

.08

-.38

-.38

-.21

.47

-.09

-.25

.00

.30

.00

PROFILE

PROFILE

ALIGNMENT

ALIGNMENT

AUTHORIZED SPEEDS

AUTHORIZED SPEEDS

30

115 / 53

115 / 55

115 / 56

115 / 56

115 / 55

M1

M1

M2

M2

← TO GILMAN
GILMAN SUBDIVISION

1" = 1800'
AUGUST 2015

TO FARMERSVILLE
MP 210.00 - 215.00
PG 27 - 28 →

215

216

217

218

5283

5283

5287

1266+37

1319+20

1372+03

1424+90

FARMERSVILLE
217.5

BR. 217.80 - 64'
MACOUPIN CREEK RCT

0.10 CIR 48" X 48'

0.40 CIR 36" X 36'

0.90 CIR 12" X 24'

0.20 CIR 24" X 36'

0.30 CIR " X 36'

0.40 CIR " X 36'

0.80 CIR " X 24'

0.30 CON 60" X 54'

TO MINE →

PROFILE

ALIGNMENT

AUTHORIZED SPEEDS

M1

M2

PROFILE

ALIGNMENT

AUTHORIZED SPEEDS

M1

M2

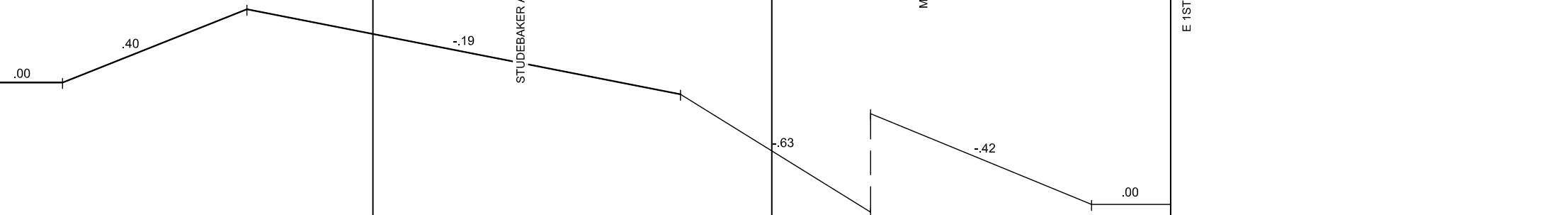

STUDEBAKER AVE 295660B F/L 0.37

PVT 295661H 0.77

MAIN 295662P F/L 0.38

E 1ST RD 292564N F/L 0.00

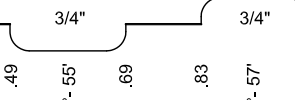

115 / 55

115 / 50

115 / 55

← TO GILMAN
GILMAN SUBDIVISION

1" = 1800'
AUGUST 2015

TO FARMERSVILLE →
MP 215.00 - 220.00 PG 28 - 28