

# CN

## SOUTHERN REGION



### CHICAGO/ CENTRAL DIVISION CHICAGO SUBDIVISION TRACK CHART

APRIL 2013

## TABLE OF CONTENTS

<i>CITY/TOWN</i>	<i>PAGE #</i>
16TH ST	1
39TH ST	1
67TH ST	2
KENSINGTON	3
WILDWOOD	3
HIGHLAWN	4
NORTH JCT.	4
SOUTH JCT.	4
HOMewood	5
VOLLMER	6
SWEDE	6
HARRIS	6
STUENKEL	7
PEOTONE	8
MANTENO	10
KANKAKEE	11
GAR CREEK	12
OTTO	12
RANE	13
CHEBANSE	13
CLIFTON	14
ASHKUM	15
NORTH GILMAN	16
GILMAN	17
DELREY	18
PAXTON	21
RANTOUL	23
LEVERETT JCT.	25

# LEGEND

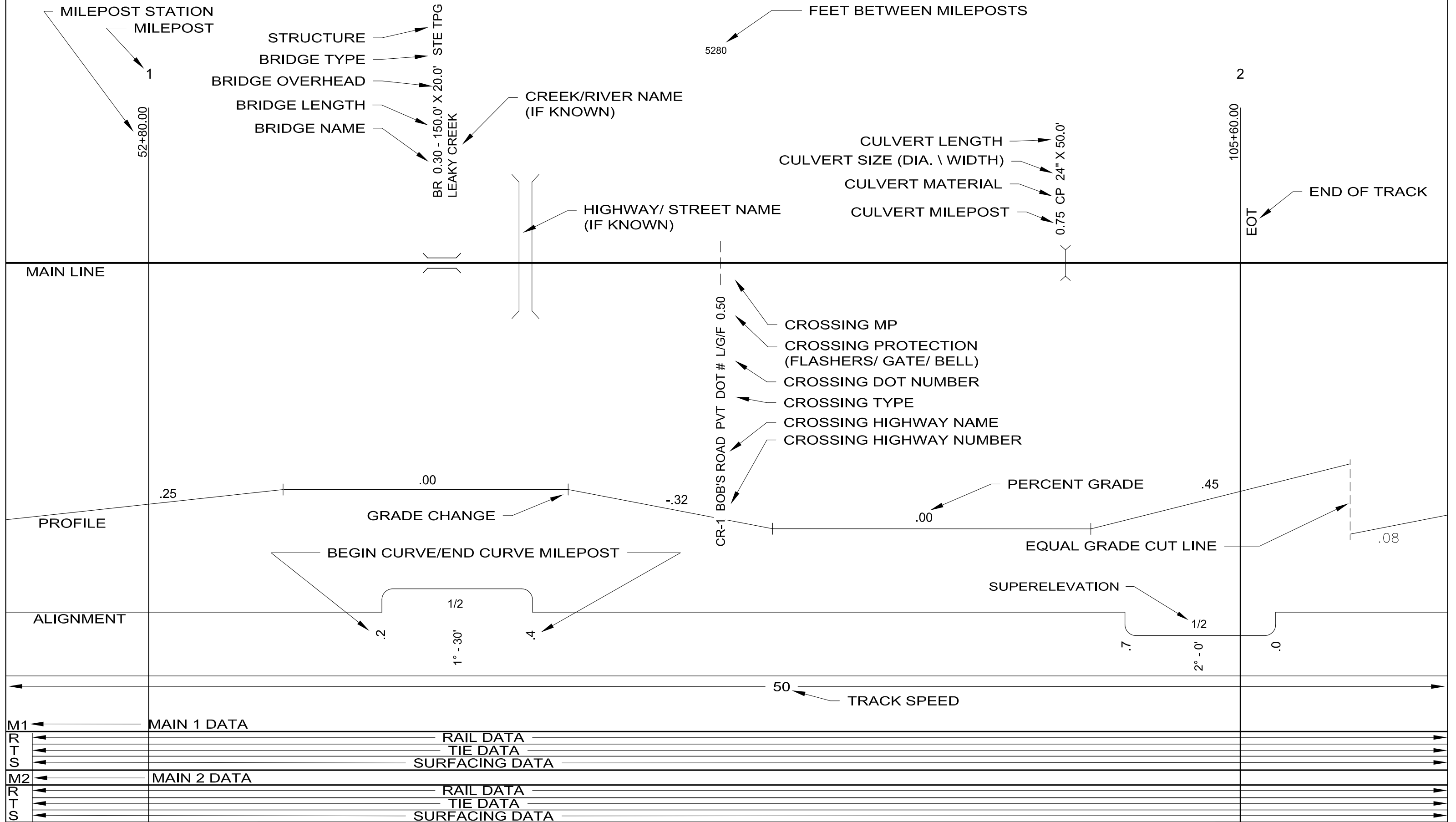

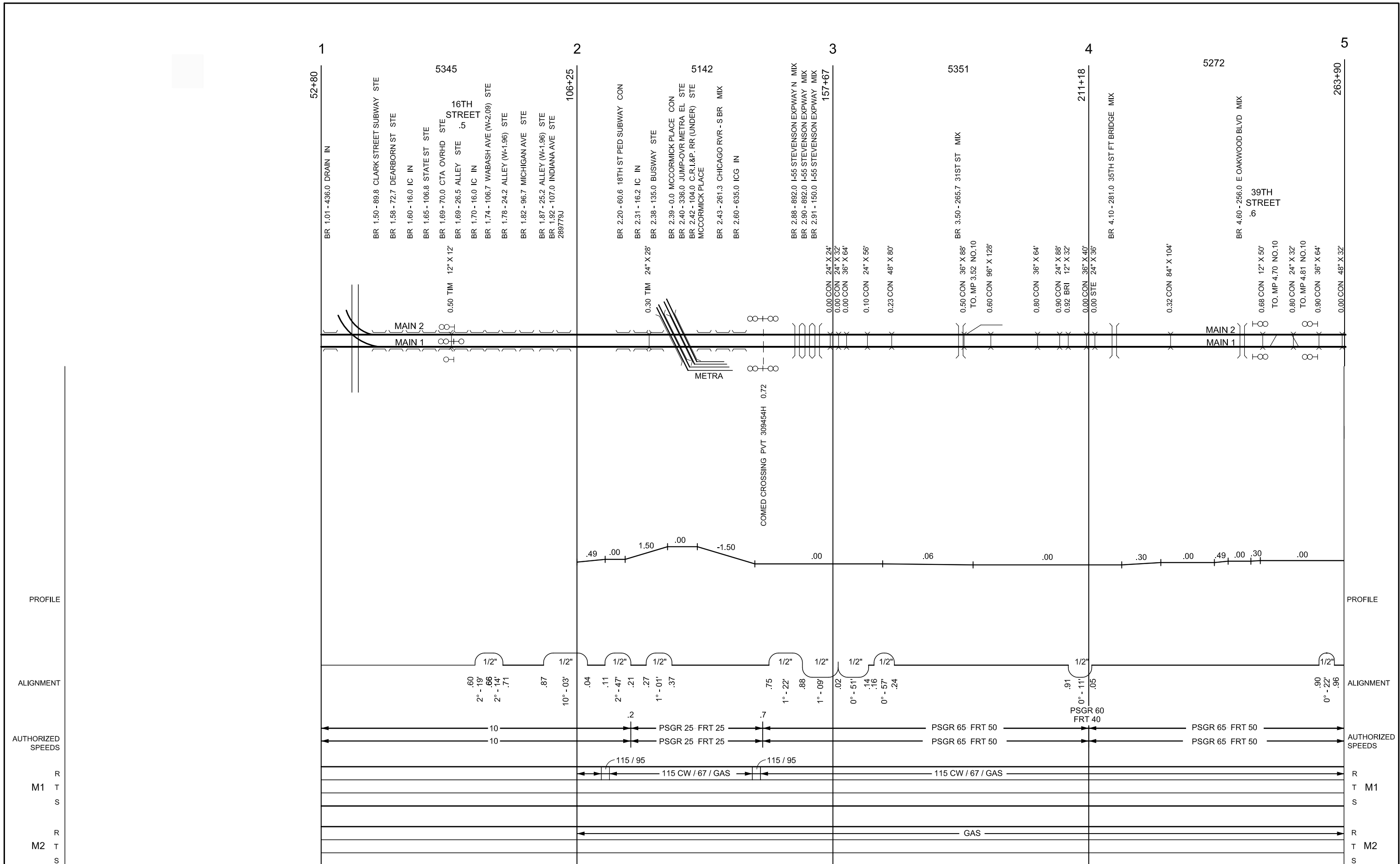

← TO CHICAGO  
CHICAGO SUBDIVISION

1" = 1800'  
APRIL 2013

TO CHAMPAIGN →  
M.P. 1.00 - 5.00 PG 01 - 26

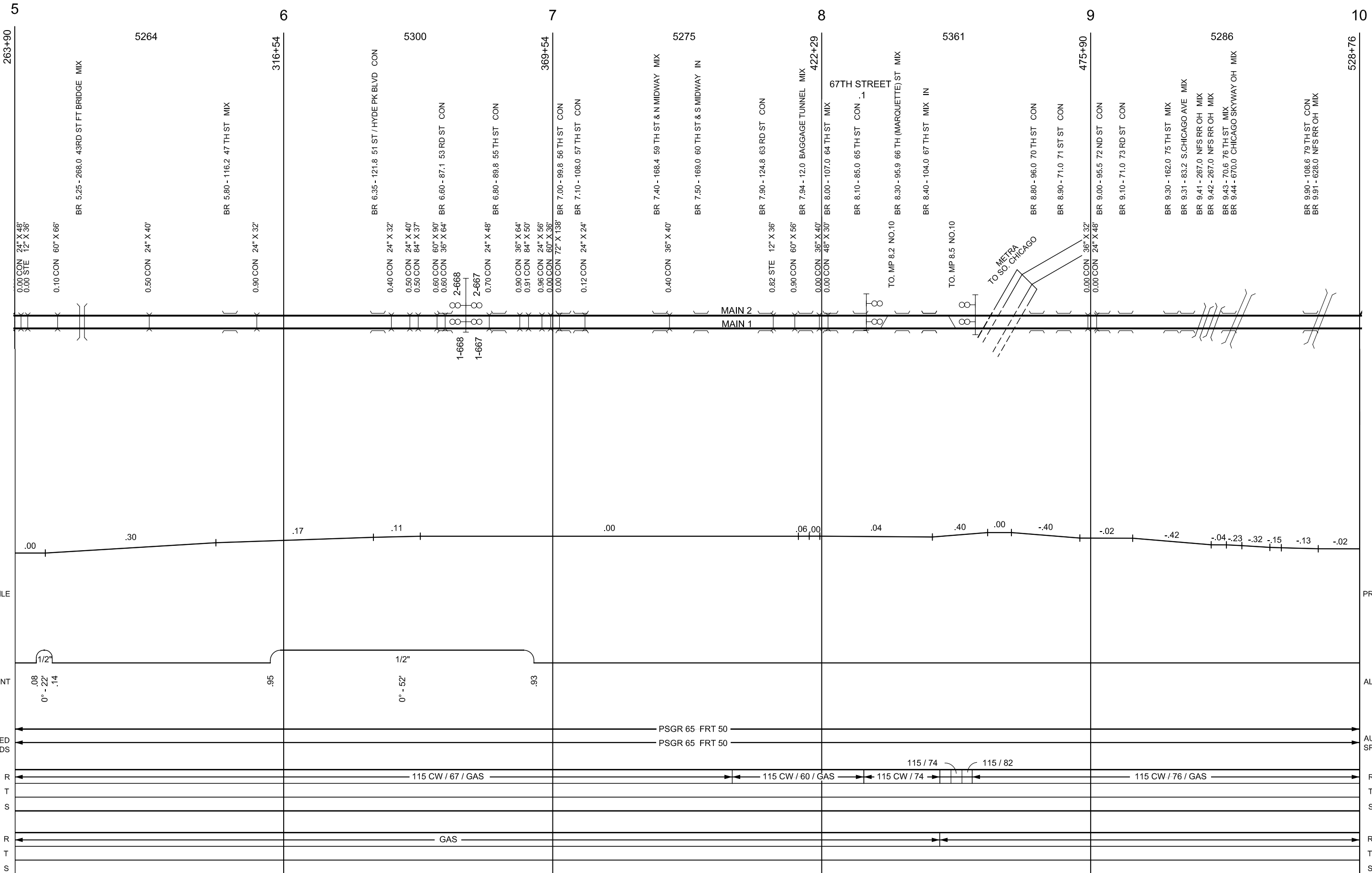

← TO CHICAGO  
CHICAGO SUBDIVISION

1" = 1800'  
APRIL 2013

TO CHAMPAIGN →  
M.P. 5.00 - 10.00 PG 02 - 26

10 11 12 13 14 15

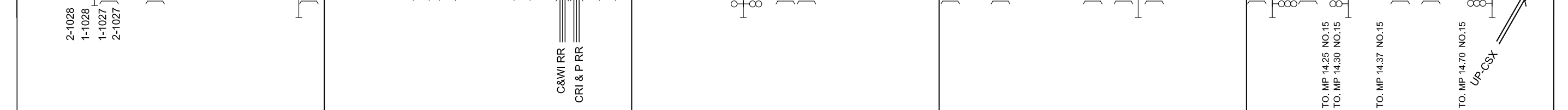
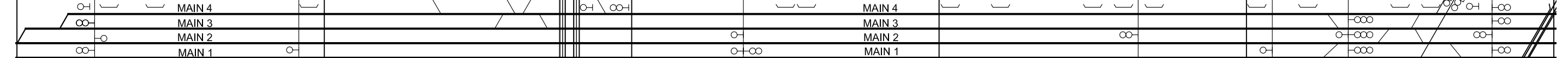
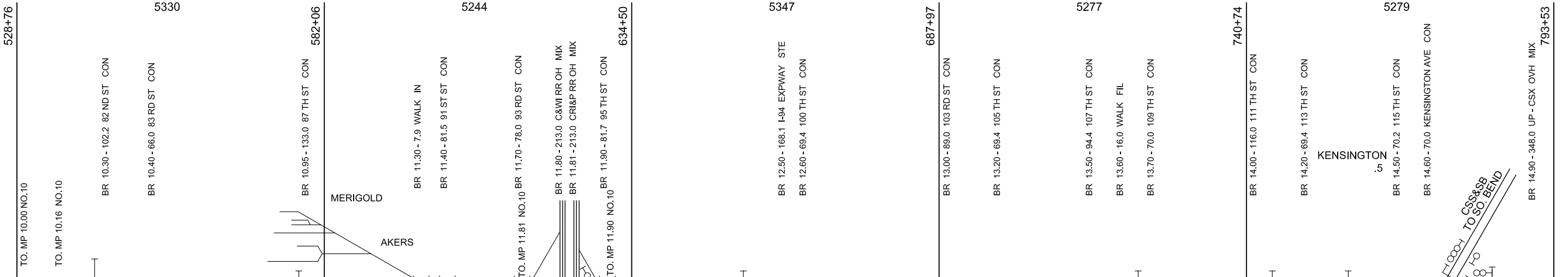

RR CROSSING MP	14.5
RR CROSSED	METRA
MAINTAINED BY	METRA
SECTION & WEIGHT	136 RBMR
CENTRAL ANGLE	13° 45' 00"
TYPE CROSSING	QUAD

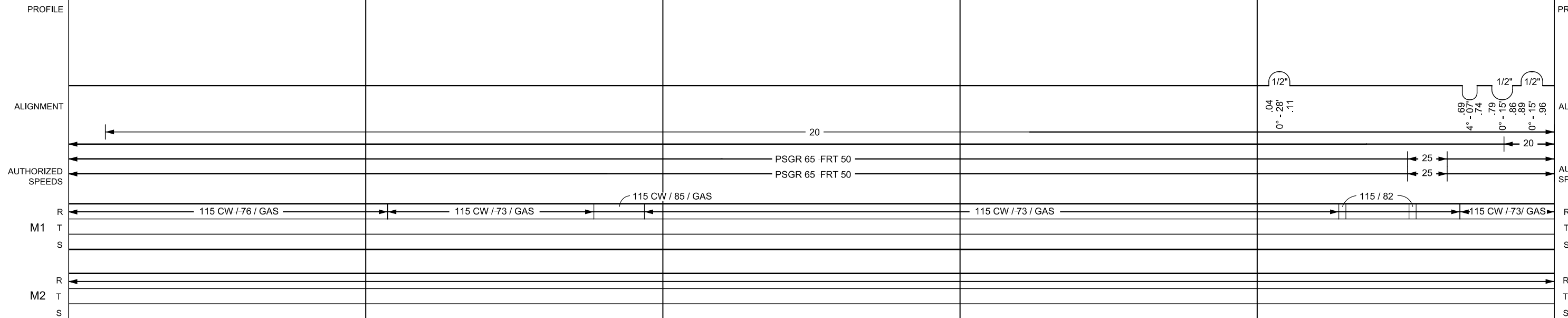

TO CHICAGO CHICAGO SUBDIVISION      1" = 1800' APRIL 2013      TO CHAMPAIGN M.P. 10.00 - 15.00 PG 03 - 26

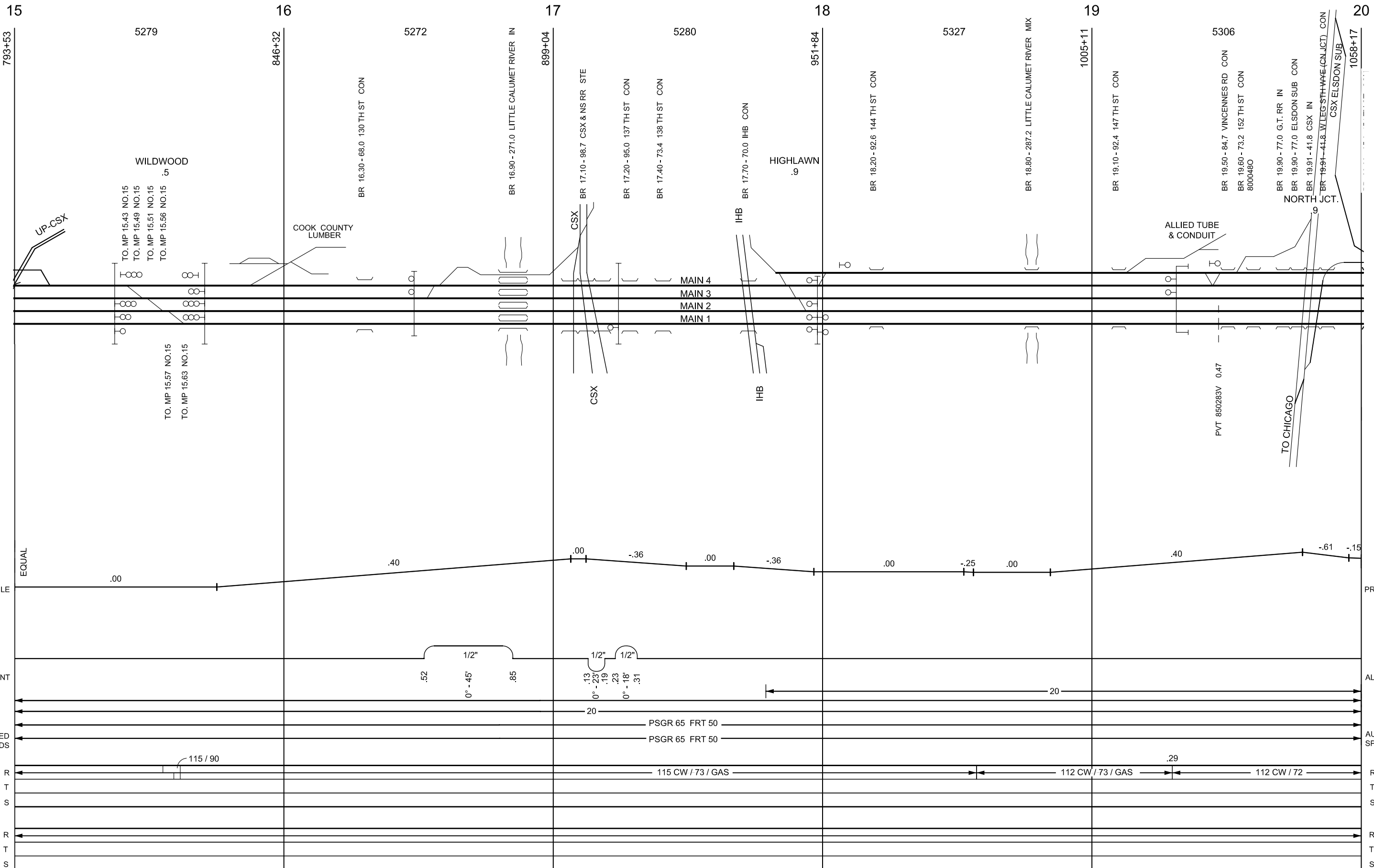

← TO CHICAGO  
CHICAGO SUBDIVISION

1" = 1800'  
APRIL 2013

TO CHAMPAIGN →  
M.P. 15.00 - 20.00  
PG 04 - 26

20 21 22 23 24 25

1058+17 5738 4533 1160+88 1216+73 5295 1269+68 5288 1322+56

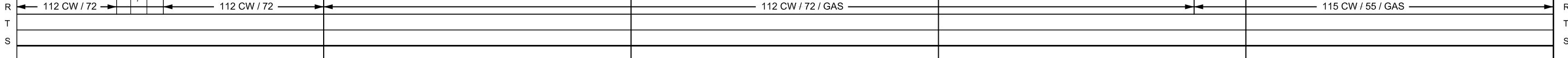
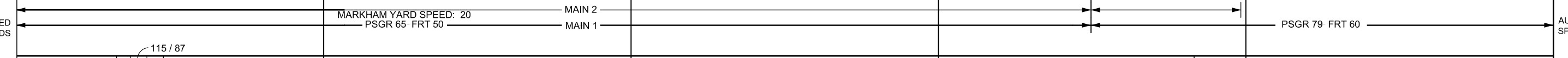
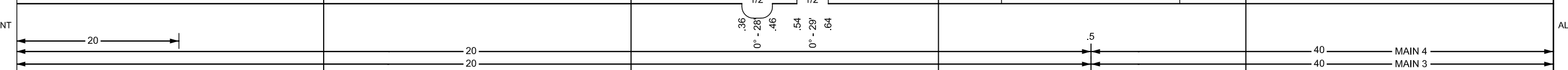
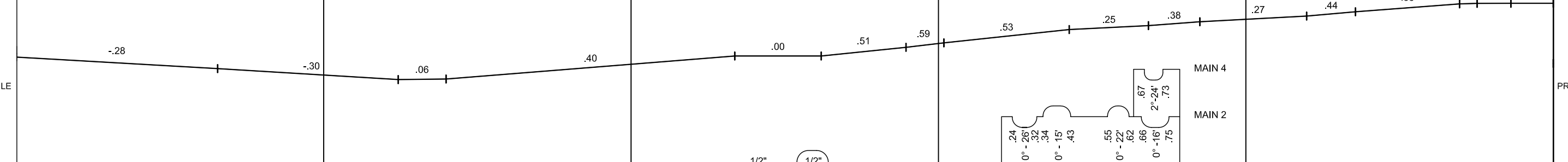
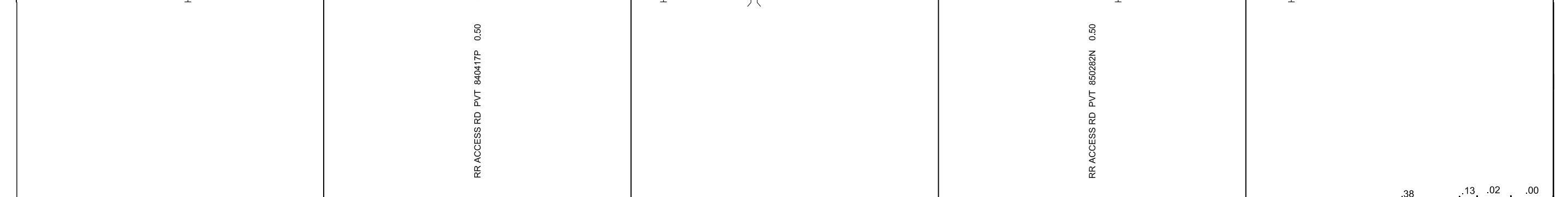
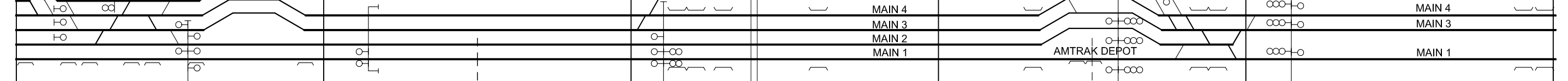
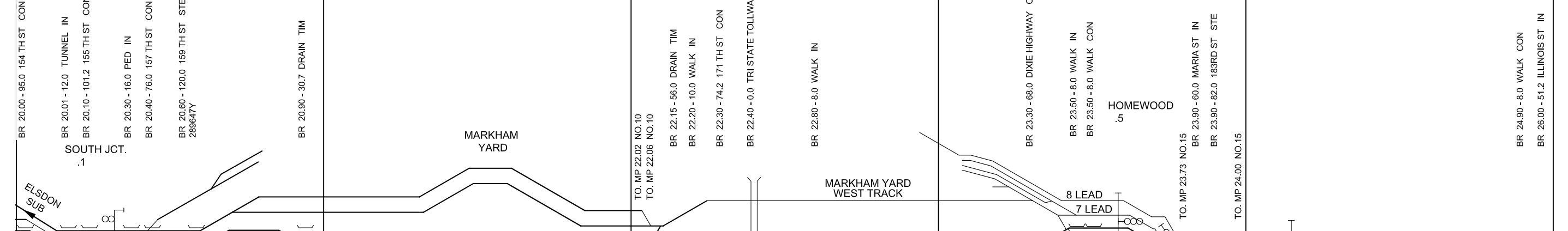

← TO CHICAGO  
CHICAGO SUBDIVISION

1" = 1800'  
APRIL 2013

TO CHAMPAIGN →  
M.P. 20.00 - 25.00 PG 05 - 26



30 31 32 33 34 35

1587+06 5280 17630+42 5290 17577+52 5288 17524+64 5293 17471+71 5293 17418+78

COOK CO.  
WILL CO.

BR 31.10 - 12.0 WALK CON

STUENKEL

STUENKEL CONNECTION TRACK (YARD 1 TRACK)

MAIN 3

MAIN 1

TO MP 31.60 NO.20  
0.70 STE 24" X 42'  
0.70 CON 24" X 16'

0.00 STE 24" X 48'  
0.00 CON 24" X 16'

TO MP 32.1 NO.10

MCINTYRE GROUP

0.50 STE 36" X 36'  
0.50 CON 36" X 16'

TO MP 32.9 NO.10

BLUELINX

TO MP 33.20 NO.10  
0.30 STE 36" X 60'  
0.30 CON 36" X 32'

335  
336

num

BR 34.10 - 191.2 COURT ST STE  
288900N

BR 34.20 - 156.0 W. MAIN ST STE  
288901V

BR 34.30 - 165.2 IC IN

BR 34.40 - 181.3 IC IN

BR 34.70 - 272.0 GOVERNORS HWY CON  
288904R

FARMERS-KENNEYS PVT 289679E 0.20

STUENKEL RD 289680Y F/G/B 0.40

DRALLE RD 289681F CANT/F/G/B 0.46

GOVERNORS GATEWAY INDUSTRIAL PARK

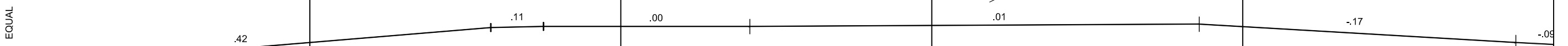

PROFILE PROFILE

ALIGNMENT ALIGNMENT

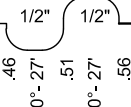

AUTHORIZED SPEEDS AUTHORIZED SPEEDS

PSGR 79 FRT 60

PSGR 79 FRT 60

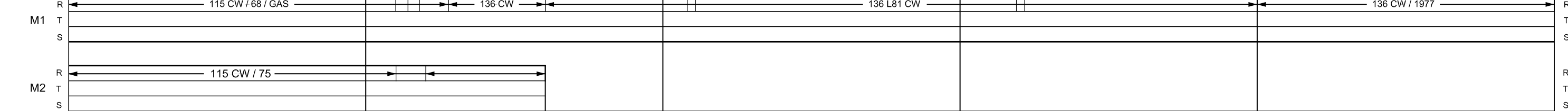

← TO CHICAGO  
CHICAGO SUBDIVISION

1" = 1800'  
APRIL 2013

TO CHAMPAIGN →  
M.P. 30.00 - 35.00  
PG 07 - 26

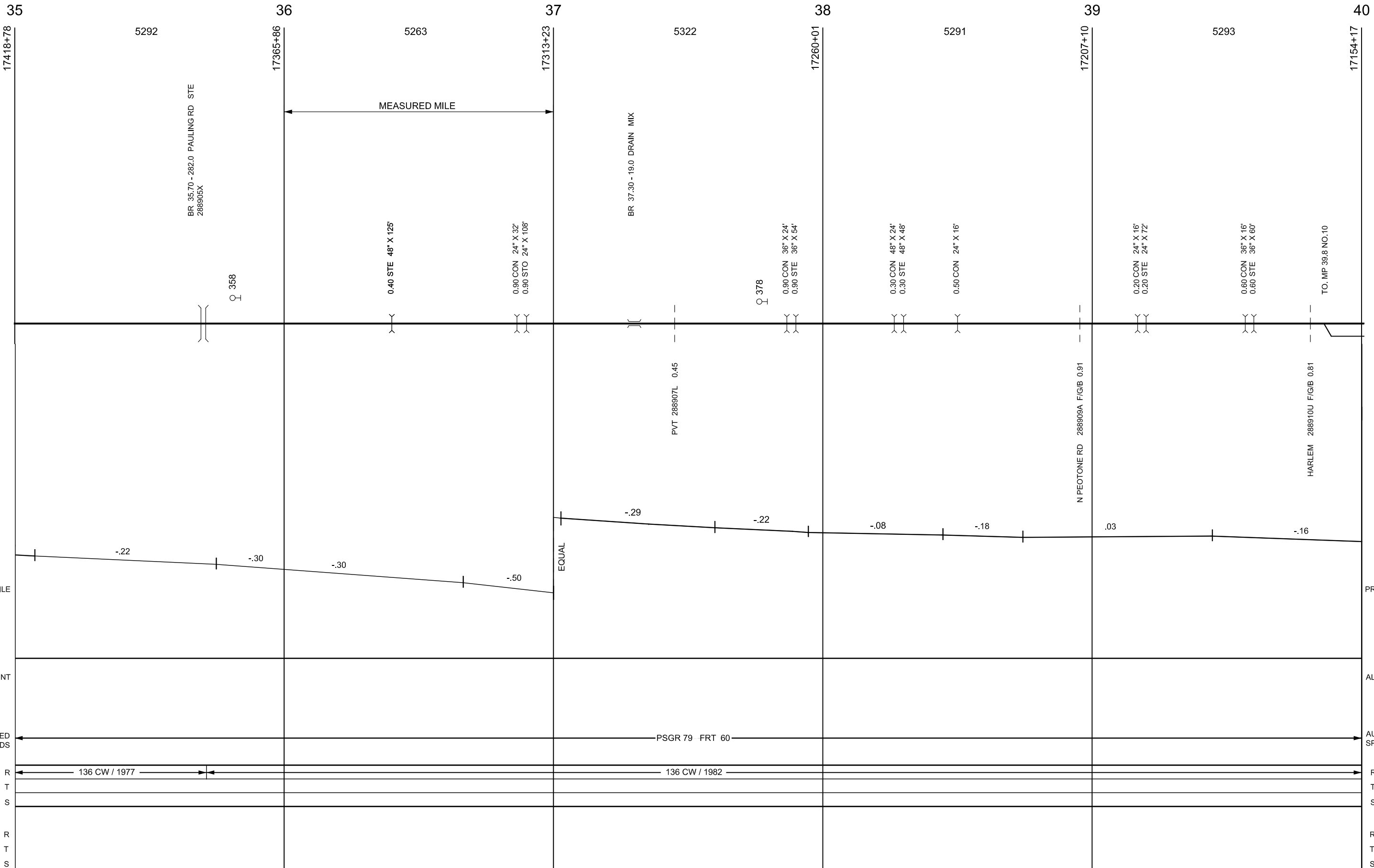

← TO CHICAGO  
CHICAGO SUBDIVISION

1" = 1800'  
APRIL 2013

TO CHAMPAIGN →  
M.P. 35.00 - 40.00  
PG 08 - 26

40 5292 41 5281 42 5276 43 5303 44 5285 45

17154+17 17101+25 17048+44 16995+68 16942+65 16889+80

PEOTONE  
10,519 FT.

WILL CO.  
KANKAKEE CO.

BLACK DIAMOND  
PIPE & TUBE

CRAWFORD ST 288911B F/G/B 0.30  
MAIN ST 288913P F/G/B 0.50  
CORNING AV 288914W F/G/B 0.60

WILMINGTON RD 288916K F/G/B 0.10

KENNEDY RD 288917S F/G/B 0.20

CR N 1200 E 288919F F/G/B 0.30

E 11000 N RD 288920A F/G/B 0.47

TO MP 41.2 NO.20  
0.20 STE 24" X 66"

0.80 CON 36" X 24"  
0.80 STE 36" X 48"

0.10 CON 36" X 16"  
0.10 STE 36" X 48"

TO MP 43.2 NO.20

0.10 CON 36" X 16"  
0.10 STE 36" X 48"

0.90 CON 36" X 16"  
0.90 STE 36" X 48"

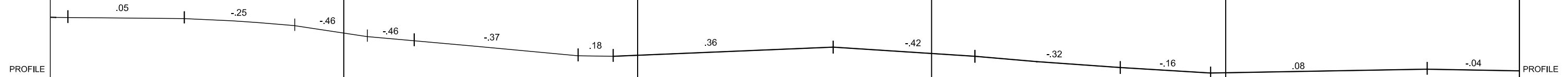

ALIGNMENT

AUTHORIZED SPEEDS

M1  
R  
T  
S

M2  
R  
T  
S

1" = 1800'  
APRIL 2013

← TO CHICAGO  
CHICAGO SUBDIVISION

TO CHAMPAIGN →  
M.P. 40.00 - 45.00  
PG 09 - 26

PSGR 79 FRT 60

40

136 CW / 1982

45 5295 46 5290 47 5312 48 5268 49 5285 50

16889+80 16836+85 16783+95 16730+83 16678+15 16625+30

5295

5290

5312

5268

5285

MANTENO  
.7

DIVERSATECH

FARMERS  
ELEVATOR

THIRD ST 288922N F/G/B 0.50  
W 1ST ST PED 288923V 0.65  
W DIVISION ST 288924C F/G/B 0.80  
E ADAMS ST 288925J F/G/B 0.90

AMBERSTONE RD 288930F F/G/B 0.00

N 6000 RD 288931M F/G/B 0.78

PROFILE .08 -0.05 .12 .12 .10 -0.44 -0.10 -0.34 .58 .44 PROFILE

ALIGNMENT .93 2-1/2" 1°-07' .34 .5 30 ALIGNMENT

AUTHORIZED SPEEDS PSGR 79 FRT 60 AUTHORIZED SPEEDS

R 136 CW / 1982 R

M1 T M1

S S

R R

M2 T M2

S S

← TO CHICAGO  
CHICAGO SUBDIVISION

1" = 1800'  
APRIL 2013

TO CHAMPAIGN →  
M.P. 45.00 - 50.00 PG 10 - 26



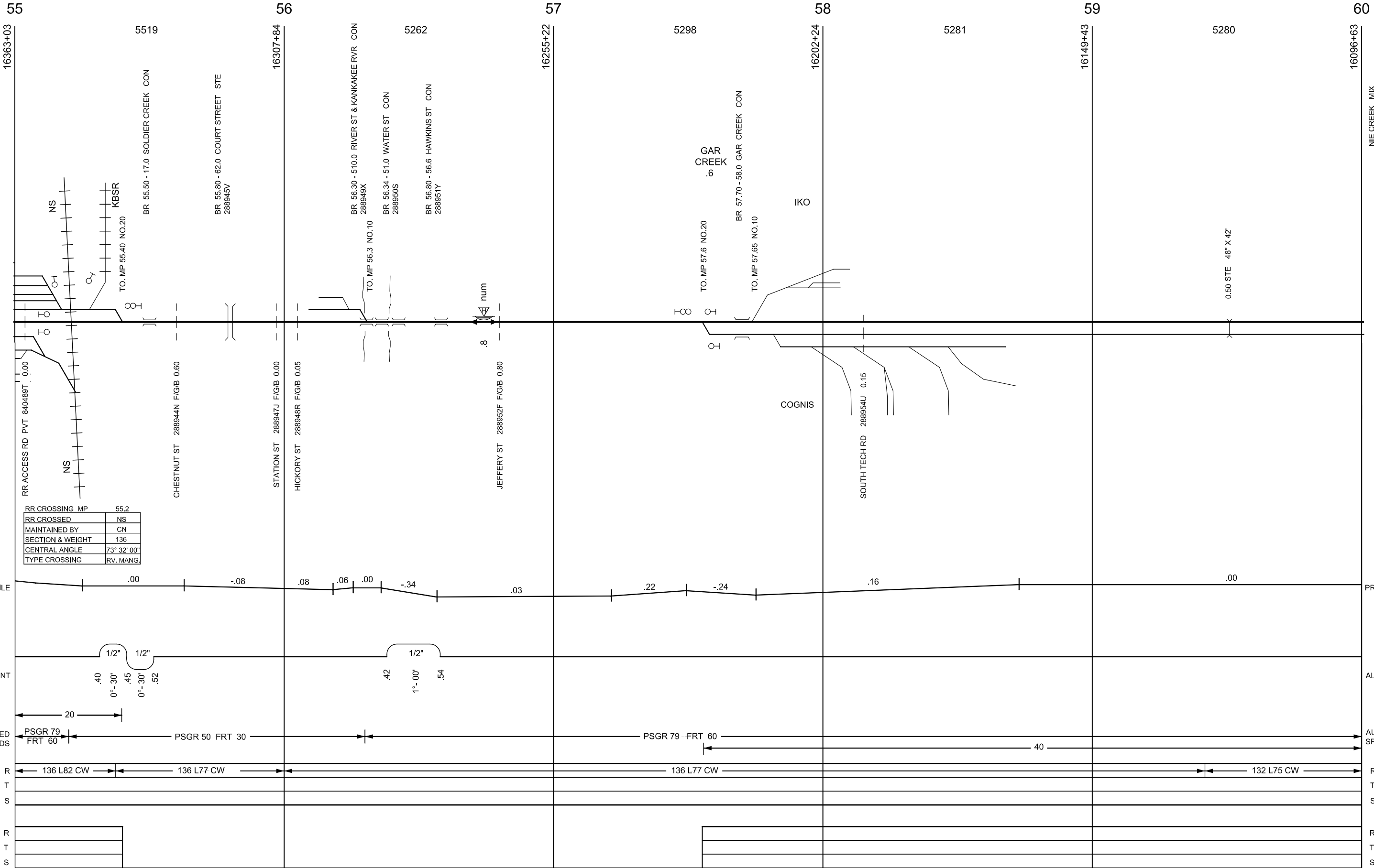

RR CROSSING MP	55.2
RR CROSSED	NS
MAINTAINED BY	CN
SECTION & WEIGHT	136
CENTRAL ANGLE	73° 32' 00"
TYPE CROSSING	RV. MANG.

TO CHICAGO  
CHICAGO SUBDIVISION

1" = 1800'  
APRIL 2013

TO CHAMPAIGN  
M.P. 55.00 - 60.00

60 5277 61 5283 62 5287 63 5270 64 5282 65

16096+63 16043+86 15991+03 15938+16 15885+46 15832+64

CHICAGO SUB CHICAGO SUB  
CHICAGO DIVISION CENTRAL DIVISION

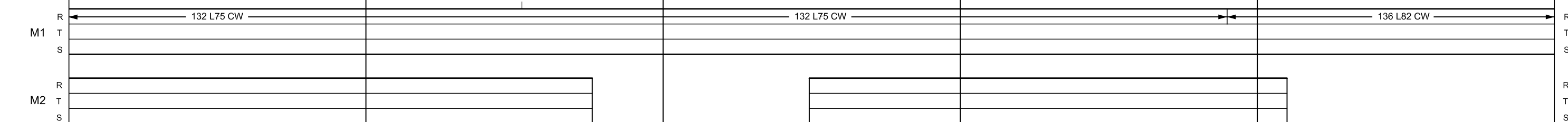
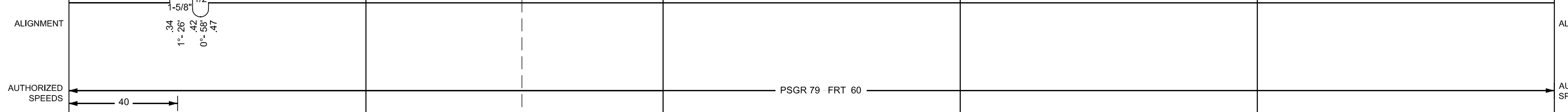
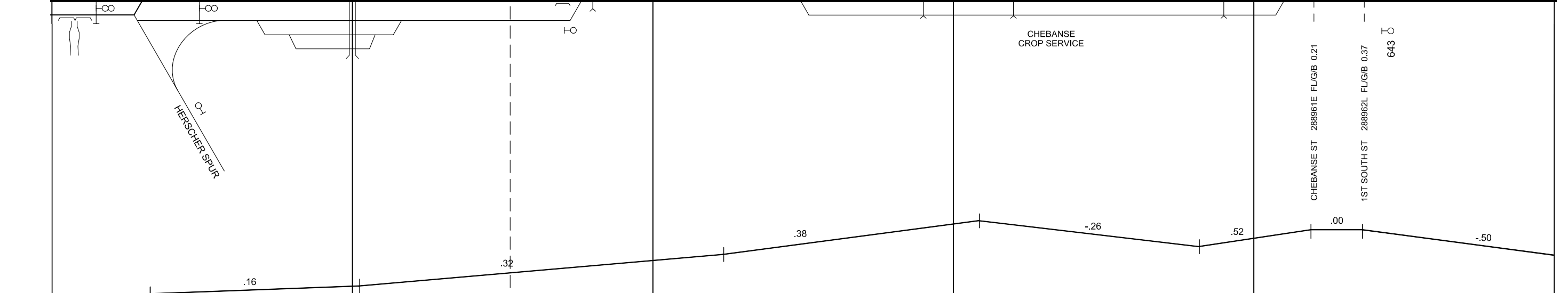
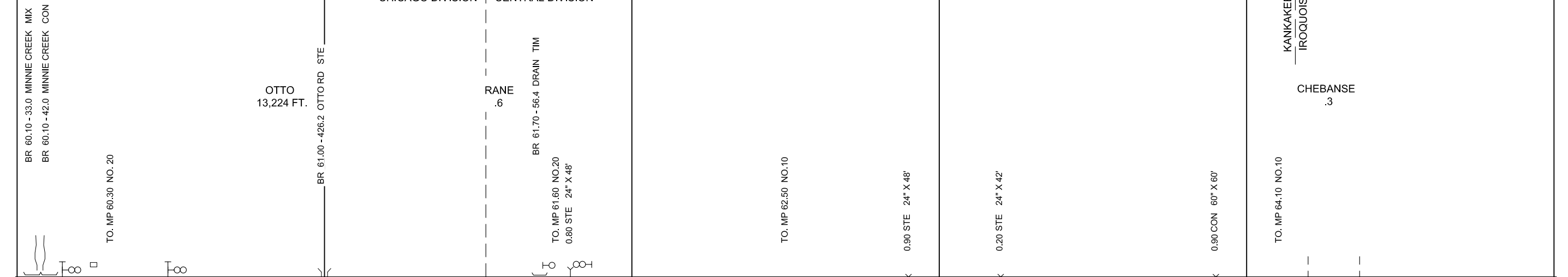

65 5280 66 5281 67 5280 68 5280 69 5280 70

15632+64 15779+84 15727+03 15674+23 15621+43 15568+63

BR 65.90 - 63.0 LANGHAM CREEK STE

BR 67.10 - 97.0 LANGHAM CREEK STE

CLIFTON  
.1

0.10 STE 36" X 54'

0.30 STE 24" X 42'

0.70 STE 36" X 42'

0.40 STE 48" X 42'

0.70 STE 48" X 42'

TO MP 68.90 NO.10

PVT 288971K 0.81



674

3100 N CENTRAL SCH RD 288965G FLG/B 0.40

WASHINGTON ST 288966N FLG/B 0.45

THIRD AVE 288967V FLG/B 0.08  
4TH AVE PED 288968C FL/B 0.15  
FIFTH AVE 288969J FLG/B 0.22

RABIDEAU &  
CLIFTON GRAIN

PROFILE

PROFILE

ALIGNMENT

ALIGNMENT

AUTHORIZED SPEEDS

AUTHORIZED SPEEDS

R  
M1  
T  
S  
  
R  
M2  
T  
S

R  
M1  
T  
S  
  
R  
M2  
T  
S

-10

-10

.00

.34

.18

.22

.00

-.22

PSGR 79 FRT 60

136 L82 CW

136 L67 CW / GAS

136 L82 CW / GAS

← TO CHICAGO  
CHICAGO SUBDIVISION

1" = 1800'  
APRIL 2013

TO CHAMPAIGN →  
M.P. 65.00 - 70.00  
PG 14 - 26

70 5280 71 5279 72 5277 73 5285 74 5278 75

15568+63 15515+83 15463+04 15410+27 15357+42 15304+64

BR 70.10 - 367.0 I-57 SOUTHBOUND STE  
BR 70.11 - 367.0 I-57 NORTHBOUND STE  
288972S

TO MP 70.60 NO.10  
0.70 STE 48" X 42"

0.20 STE 48" X 50'

0.40 STE 36" X 62'

2700 N RD 288974F X 0.65

ASHKUM  
11,025 FT.

0.40 CON 36" X 24'

TO MP 72.9 NO.10

ASHKUM  
.1

0.30 MIX 60" X 40'

TO MP 73.4 NO.10

0.10 MIX 72" X 40'

Ω 748

2800 N RD 288973Y FL/G/B 0.60

TRI CENTRAL  
CO - OP GRAIN

IL RTE 116 288976U FL/G/B 0.70

MAIN ST 288977B FL/G/B 0.00

2400 N RD 288978H FL/G/B 0.85

.02 .04 .04 .10 -.30 -.02 -.24

PROFILE

PROFILE

ALIGNMENT

ALIGNMENT

AUTHORIZED SPEEDS

AUTHORIZED SPEEDS

R  
M1  
T  
S

R  
M1  
T  
S

R  
M2  
T  
S

R  
M2  
T  
S

40  
136 L82 CW / GAS

PSGR 79 FRT 60

136 L79 CW

← TO CHICAGO  
CHICAGO SUBDIVISION

1" = 1800'  
APRIL 2013

TO CHAMPAIGN →  
M.P. 70.00 - 75.00  
PG 15 - 26

1/2" 1/2"  
.78  
0°-09'  
.85  
0°-58'  
.91

1/2" 1/2"  
.71  
0°-14'  
.89  
0°-16'  
.96

75

76

77

78

79

80

15304+64

15251+86

15145+60

15093+43

15040+63

5278

5280

5346

5217

5280

0.20 STE 48" X 48"

0.60 STE 48" X 42"  
0.63 STE 36" X 60"

0.00 STE 24" X 48"

0.40 STE 48" X 42"

0.80 STO 24" X 29"

TO MP 77.30 NO.10

TO MP 77.60 NO.10  
BR 77.60 - 34.0 DRAIN CON

0.10 STO 24" X 25"

BR 78.70 - 47.0 PRAIRIE CREEK STE

TO MP 79.30 NO.10

0.40 STE 36" X 54"

TO MP 79.80 NO.10

DANFORTH  
.4

N. GILMAN  
.4

766  
767

num  
.9

2300 N 288979P X 0.90

NORTH ST 288980J FL/G/B 0.95

PED 288981R B 0.20

JEFFERSON ST 288982X FL/G/B 0.33

CR 2100 N 288983E FL/G 0.00

TR 551 2000 N 288984L X 0.07

PROFILE

PROFILE

ALIGNMENT

ALIGNMENT

AUTHORIZED SPEEDS

AUTHORIZED SPEEDS

R

R

M1

M1

T

T

S

S

R

R

M2

M2

T

T

S

S

.14

.02

.02

.12

.01

.00

-.22

.00

-.12

.28

-.18

.87

1/2"

0°-45'

.20

PSGR 79 - FRT 60

136 L79 CW

136 L82 CW

136 L79 CW

136 L82 CW

136 L79 CW

← TO CHICAGO  
CHICAGO SUBDIVISION

1" = 1800'  
APRIL 2013

TO CHAMPAIGN →  
M.P. 75.00 - 80.00  
PG 16 - 26

80 81 82 83 84 85

15040+63 5281 14987+82 5281 14935+01 5280 14882+21 5281 14829+40 5279 14776+61

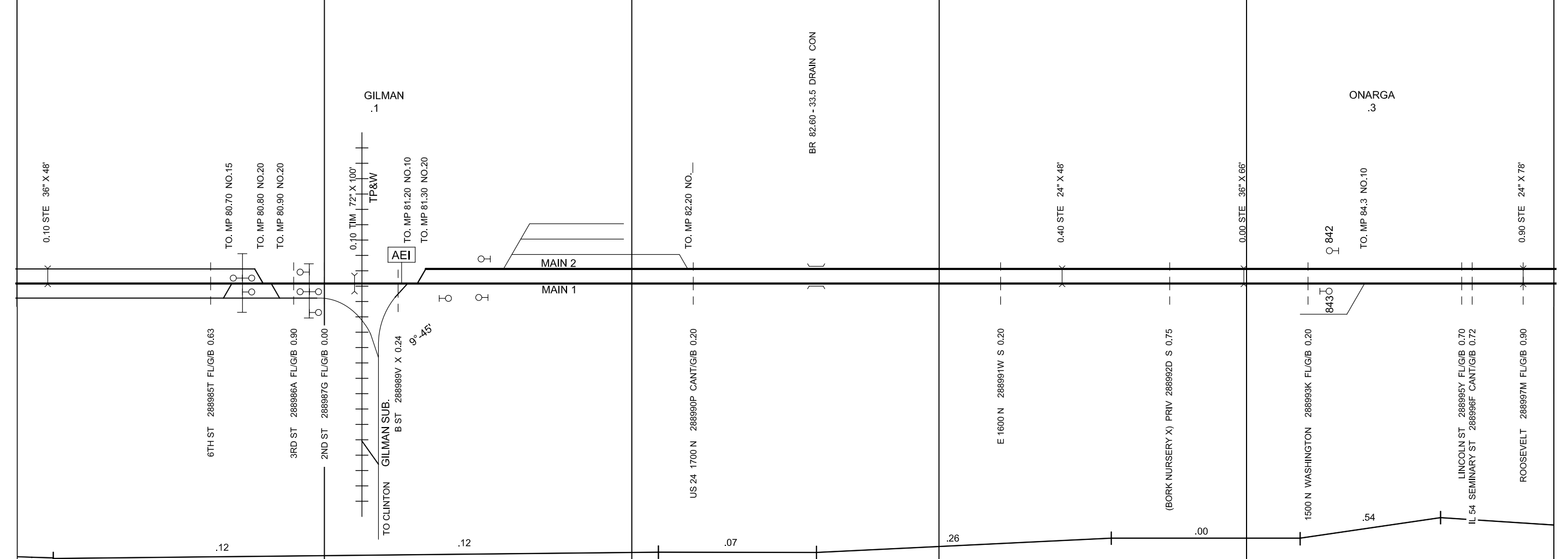

RR CROSSING MP	81.1
RR CROSSED	T.P. & W
MAINTAINED BY	CN
SECTION & WEIGHT	132
CENTRAL ANGLE	77° 41' 30"
TYPE CROSSING	3 BOLT R.

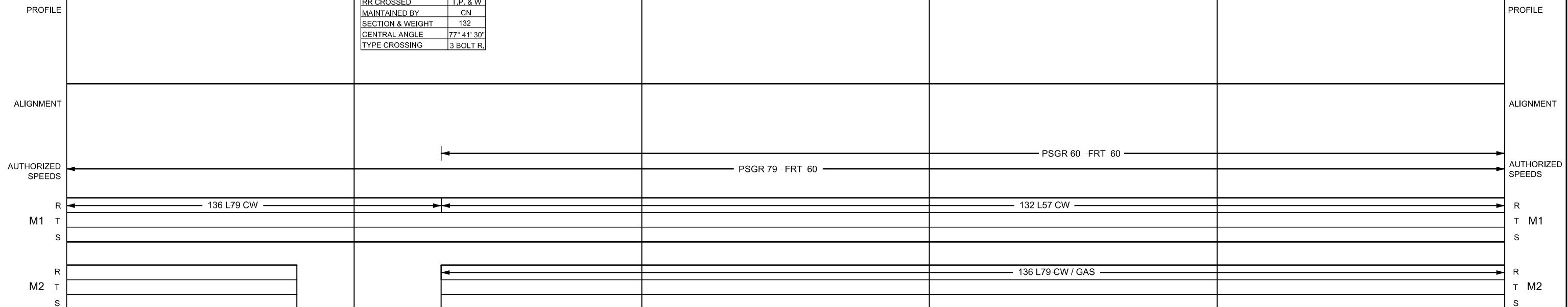

85

86

87

88

89

90

14776+61 5280 14723+81 5277 14671+04 5613 14614+91 4948 14565+43 5280 14512+63

0.40 STE 48" X 42'

0.40 STE 24" X 42'

0.20 STE 48" X 72'

0.80 STE 24" X 54'

0.10 STE 12" X 48'

0.90 STE 24" X 48'

MAIN 2

MAIN 1

DELREY .6

TO. MP 87.3 NO.20

BR 87.90 - 54.8 NORTH SPRING CREEK STE

num

.6

NORTH ST (1190 N) 288998U FLGIB 0.55

TR50 1160 N 289001H X 0.10

TR269 1100 N 289002P FLGIB 0.40

-38 .12 .12 .00 -.32 .24 -.20 .22 .00

PROFILE

PROFILE

ALIGNMENT

ALIGNMENT

AUTHORIZED SPEEDS

AUTHORIZED SPEEDS

PSGR 60 FRT 60

.3

PSGR 79 FRT 60

132 L67 CW

136 L79 CW

136 L82 CW

M1

M1

M2

M2

136 L79 CW

← TO CHICAGO  
CHICAGO SUBDIVISION

1" = 1800'  
APRIL 2013

TO CHAMPAIGN →  
M.P. 85.00 - 90.00  
PG 18 - 26

90

91

92

93

94

95

14512+63

5286

14459+77

5283

14406+94

5281

14354+13

5285

14301+28

5276

14248+52

0.60 STE 24" X 48'

BR 91.10 - 52.0 AMES CREEK CON

PVT 289005K 0.40

ROBERTS RD 800 N 289006S FL/G/B 0.50

MAIN ST 289007Y FL/G/B 0.85

PED PUB 0.98

LINCOLN ST 289009M FL/G/B 0.10

0.30 STE 24" X 48'

TR327 700 N 289010G FL/G/B 0.56

0.70 STE 60" X 48'

PVT 289011N 0.20

941 942

0.50 STE 24" X 42'

TR565 600 N 289012V X 0.60

.18

.08

.08

.18

.34

.21

EQUAL

.21

.18

-.16

PROFILE

PROFILE

ALIGNMENT

ALIGNMENT

1-1/2"  
0° - 46'

AUTHORIZED SPEEDS

AUTHORIZED SPEEDS

PSGR 79 - FRT 60

136 L82 CW

R  
M1  
T  
S  
  
R  
M2  
T  
S

R  
M1  
T  
S  
  
R  
M2  
T  
S

← TO CHICAGO  
CHICAGO SUBDIVISION

1" = 1800'  
APRIL 2013

TO CHAMPAIGN →  
M.P. 91.00 - 96.00  
PG 19 - 26

95 5287 96 5284 97 5280 98 5258 99 5303 100

14248+52 14195+65 14142+81 14090+01 14037+43 13984+40

BR 95.30 - 54.8 SOUTH SPRING CREEK STE

PVT 289013C 0.60  
TR609 500 N 289014J X 0.65  
0.70 STE 48" X 42'

TR349 400 N 289015R FL/G/B 0.70

0.10 STE 60" X 44'

TR357 300 N 289016X X 0.80

984

JEFFERSON/ NORTH 1ST ST 289017E FL/G/B 0.71

SECOND ST 289018L FL/G/B 0.90

0.30 STE 24" X 60'

BR 99.60 - 12.0 DRAIN CON

POPEL AG CENTER

TR367A 100 N 289020M FL/G/B 0.90  
TO MP 99.90 NO.10

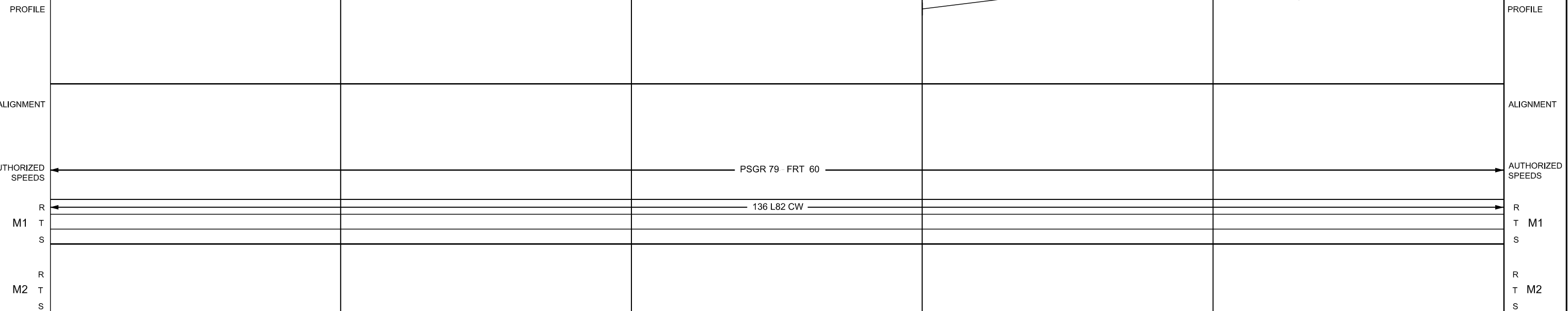

← TO CHICAGO  
CHICAGO SUBDIVISION

1" = 1800'  
APRIL 2013

TO CHAMPAIGN →  
M.P. 95.00 - 100.00 PG 20 - 26

100

101

102

103

104

105

13984+40

5282

13931+58

5284

13878+74

5282

13825+92

5276

13773+16

5280

13720+36

IROQUOIS CO.  
FORD CO.

PAXTON  
14,518 FT.

PAXTON  
.8

TO MP 100.70 NO.20

BR 102.00 - 15.0 FORD SPC DITCH MIX

BR 102.80 - 135.5 W HOLMES ST CON  
BR 102.90 - 132.0 PELL ST CON  
289027K

BR 103.10 - 126.7 IC STE  
289029Y  
BR 103.20 - 132.0 PATTON ST STE  
289030T

TO MP 103.60 NO.20

IL. GRAIN

PVT 289021U 0.50

TR85 S 600 N 289022B FL/G/B 0.95

TR91A 500 N 289023H FL/G/B 0.01

TO MP 102.25 NO.10

-03

-58

-42

-30

.64

-.29

-.29

-.22

-.03

EQUAL

PROFILE

PROFILE

ALIGNMENT

ALIGNMENT

AUTHORIZED SPEEDS

AUTHORIZED SPEEDS

40

PSGR 79 FRT 60

R

M1

T

S

R

M1

T

S

R

M2

T

S

R

M2

T

S

1" = 1800'  
APRIL 2013

← TO CHICAGO  
CHICAGO SUBDIVISION

TO CHAMPAIGN →  
M.P. 100.00 - 105.00 PG 21 - 26

105

106

107

108

109

110

5280

5281

5280

5280

5282

13720+36

13537+56

13614+75

13561+95

13509+15

13456+33

BR 106.00 - 123.5 VERMILLION RIVER

BR 106.80 - 92.0 DRAIN & SLOUGH IN

FORD CO.  
CHAMPAIGN CO.

BR 107.50 - 158.5 VERMILLION RIVER IN

LUDLOW  
.3

BR 109.30 - 24.0 UPPER SALT FORK DITCH CON

TR105A PIT ROAD (200 N) 289032G FL/GIB 0.20

LEHIGH RD 289033N FL/GIB 0.25

TR3A 3600 N 289034V X 0.30

THOMAS ST 289035C FL/GIB 0.30

TR27B 3400 N 289037R FL/GIB 0.70

PVT 289038X 0.80

-.16

.30

.30

-.16

.40

PROFILE

PROFILE

ALIGNMENT

ALIGNMENT

AUTHORIZED SPEEDS

AUTHORIZED SPEEDS

M1

M1

M2

M2

PSGR 79 FRT 60

136 L82 CW

← TO CHICAGO  
CHICAGO SUBDIVISION

1" = 1800'  
APRIL 2013

TO CHAMPAIGN →  
M.P. 105.00 - 110.00 PG 22 - 26

110

111

112

113

114

115

5281

5279

5282

5279

5278

13456+33

13403+52

13350+73

13297+91

13192+34

13192+34

0.00 STE 36" X 54'

0.40 STE 36" X 54'

0.90 STE 36" X 54'

0.40 STE 36" X 42'

0.90 STE 24" X 48'

0.70 STE 36" X 72'

PVT 289039E 0.20

HOUSTONVILLE RD 3300 N 289040Y FL/G/B 0.50

TR37A 3200 N 289041F FL/G/B 0.60

TO MP 113.40 NO.10

DEWEY SPUR  
CAMPBELL AVE 289042M FL/G/B 0.56

GROVE AVE 289044B FL/G/B 0.75

SANGAMON AVE 289045H FL/G/B 0.85

PVT 289047W 0.85

RANTOUL  
.8

RANTOUL  
14,208 FT.

SHAW READY  
MIX

BR 0.00 - 82.0 US RT 136  
8003030

.00

-.53

-.58

.34

-.16

PROFILE

PROFILE

ALIGNMENT

ALIGNMENT

AUTHORIZED SPEEDS

AUTHORIZED SPEEDS

PSGR 79 FRT 60

PSGR 60 FRT 60

PSGR 79 FRT 60

40

M1  
R  
T  
S

M1  
R  
T  
S

136 L82 CW

M2  
R  
T  
S

M2  
R  
T  
S

← TO CHICAGO  
CHICAGO SUBDIVISION

1" = 1800'  
APRIL 2013

TO CHAMPAIGN →  
M.P. 110.00 - 115.00 PG 23 - 26

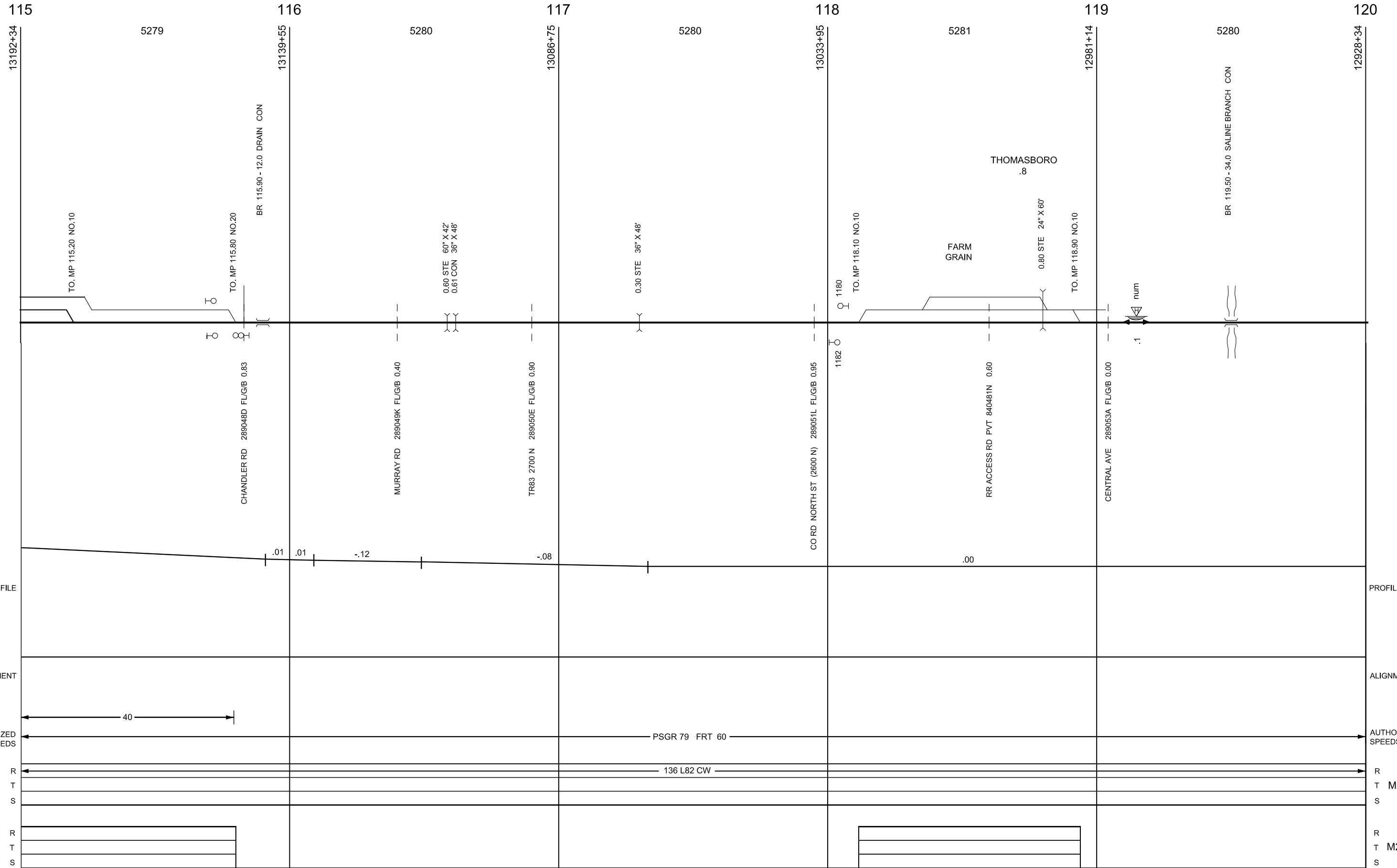

← TO CHICAGO  
CHICAGO SUBDIVISION

1" = 1800'  
APRIL 2013

TO CHAMPAIGN →  
M.P. 115.00 - 120.00 PG 24 - 26

120

121

122

123

124

5381

5280

5283

5280

12928+34

12874+53

12821+73

12768+90

12716+10

0.50 STE 48" X 48"

BR 33.30 - 121.3 SALINE BRANCH STE

BR 121.70 - 34.0 SALINE BRANCH STE

BR 122.40 - 33.5 SALINE BRANCH STE

LEVERETT  
5

TO MP 122.40 NO.10

0.70 STE 24" X 48"

0.20 STE 24" X 42"

0.80 STE 36" X 42"

0.00 STE 36" X 42"

CHAMPAIGN SUB.

END CHICAGO SUB.

LEVERETT JCT.

TR 107A 2400 N 289054G S 0.10

TR 113B 2300 N 289055N X 0.65

PVT 289056V 0.01

PVT 289057C 0.32

TR 121A 2200 N 289058J X 0.80

LEVERETT RD 289060K FL/G/B 0.60

PVT 289059R 0.25

TR 141A FORD HARRIS RD 289061S FL/G/B 0.90

.00

-.08

-.08

.00

.12

.00

.06

.00

PROFILE

PROFILE

ALIGNMENT

ALIGNMENT

AUTHORIZED SPEEDS

AUTHORIZED SPEEDS

M1

M1

M2

M2

1/2" 1/2" 1/2"  
.94 .02 .09 .14 .16 .23 .14 .34  
0°-14' 0°-14' 0°-14'

PSGR 79 FRT 60

136 L82 CW

136 L77 CW

TO CHICAGO  
CHICAGO SUBDIVISION

1" = 1800'  
APRIL 2013

TO CHAMPAIGN  
M.P. 120.00 - 125.00  
PG 25 - 26

SEE CHAMPAIGN SUBDIVISION

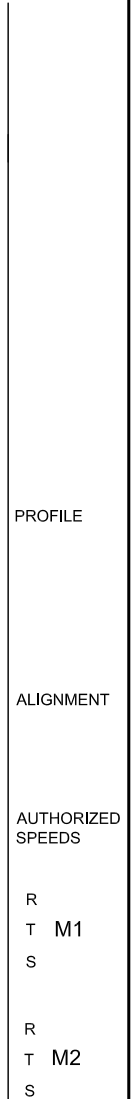
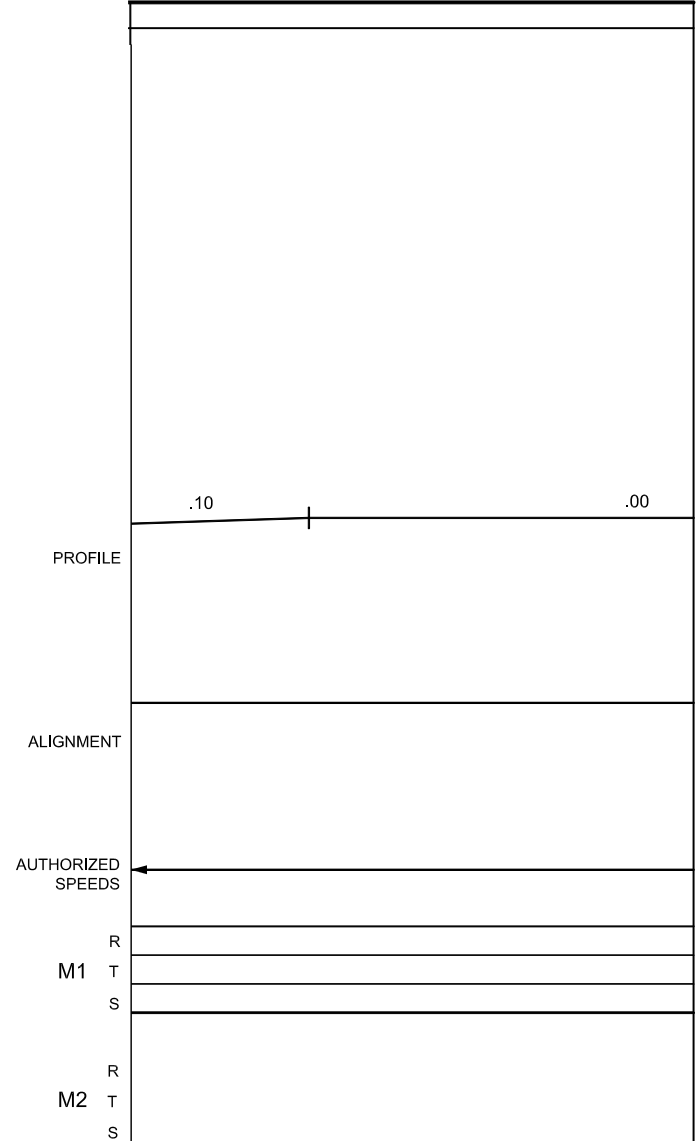
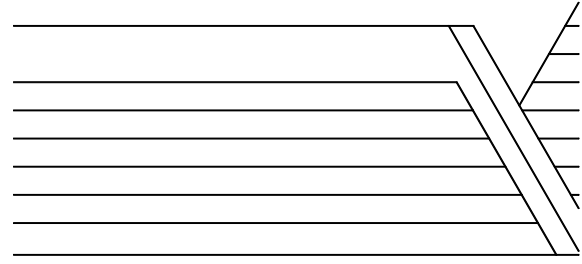

← TO CHICAGO  
CHICAGO SUBDIVISION

1" = 1800'  
APRIL 2013

TO CHAMPAIGN →  
M.P. 125.00 - 130.00 PG 26 - 26